

Kenton C. Ward, CFM
Surveyor of Hamilton County
Phone (317) 776-8495
Fax (317) 776-9628

Suite 188
One Hamilton County Square
Noblesville, Indiana 46060-2230

February 3, 2009

To: Hamilton County Drainage Board

Re: Moffitt Williamson Drain – Martin Marietta Materials Relocation

Attached are petitions and plans for the proposed relocation of the Moffitt Williamson Drain, Asa Williamson Arm and Asa Williamson Extension Arm. The relocation is being proposed by Martin Marietta Materials, Inc. Petitions for Relocation and Reconstruction have been submitted by Martin Marietta Materials, the parent company of American Aggregates Corporation that owns parcel 17-14-09-00-00-002.000, and E. & H. Mueller Development, LLC, which owns parcel 17-14-09-00-00-003.000. The proposal is to relocate the existing Moffitt Williamson open drain from Sta. 56+31 to Sta. 84+63 so that it is out of the way of the proposed mining operation that will expand onto these parcels.

The relocated drain shall consist of 4,110 feet of open drain from Sta. 56+31 to Sta. 84+63. The open ditch is as shown on the construction plans prepared by Weihe Engineers, having job number W00-0285, original date of November 10, 2000, and stamp approved by HCSO on December 9, 2008.

The drain in total will consist of the following lengths:

4,110 feet of open ditch

The total length of new drain shall be 4,110 feet. The 2,832 feet of the original Moffitt Williamson Drain, including 2,444 feet of the Moffitt Williamson Drain, Asa Williamson Arm from Sta. 56+31 to Sta. 80+75 per the original 1951 legal description, and 388 feet of the Moffitt Williamson Drain, Asa Williamson Extension Arm from Str. 80+75 to Sta. 84+63 per the original 1983 legal description, shall be vacated. This proposal will add an additional 1,278 feet to the Moffitt Williamson Drain.

The cost of the relocation is to be paid by Martin Marietta Materials, Inc.

It is proposed that the maintenance of the 4110 feet of the relocated Moffitt Williamson Drain between the original Sta. 56+31 and original Sta. 84+63 will be the responsibility of Martin Marietta Materials, Inc. A formal agreement will be presented to the Hamilton County Drainage Board in the future for approval and then recorded in the office of the Hamilton County Recorder. At this time the agreement is being reviewed by the Board's attorney.

The petitioner has provided the Performance Bond as follows:

Name of Bonding Company: SAFECO Insurance Company of America
Bond Number: 6584849
Bond Date: January 21, 2009
Bond Amount: \$655,000.00

In addition to the easement on the parcels this project is within, new easement will be placed on parcel 17-14-09-00-001.000, which is owned by American Aggregates Corporation.

The easements for the drain will be the statutory 75' easement from the top of bank of the drain. Attached are two requests for non-enforcements of easement for encroachment of the mining operations within 30 feet of the top of bank. The Board approved these requests with the approval of this petition for relocation.

I recommend the Board set this item for hearing for April 27, 2009.

Sincerely,

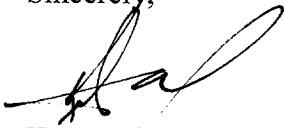

Kenton C. Ward, CFM
Hamilton County Surveyor

KCW/pll

HAMILTON COUNTY DRAINAGE BOARD
NOBLESVILLE, INDIANA

IN RE: E. & H. Mueller Development, LLC)
Hamilton County, Indiana)

PETITION FOR RELOCATION AND RECONSTRUCTION

E. & H. Mueller Development, LLC (hereinafter "Petitioner"),
hereby petitions the Hamilton County Drainage Board for authority to relocate and improve a
section of the Moffitt & Williamson Drain, and in support of
said petition advises the Board that:

1. Petitioner owns real estate through which a portion of the Moffitt & Williamson Drain runs.
2. Petitioner plans to develop its real estate with ~~roads, buildings, utilities, storm drains, sanitary sewers and other structures.~~ the expansion of an aggregate mine.
3. Petitioner's proposed development of its real estate will require relocation and reconstruction of a portion of the Moffitt & Williamson Drain, as specifically shown on engineering plans and specifications filed with the Hamilton County Surveyor.
4. The work necessary for the proposed relocation and reconstruction will be undertaken at Martin Marietta Materials, Inc. the sole expense of ~~the Petitioner~~ and such work will result in substantial improvement to the Moffitt & Williamson Drain, without cost to other property owners on the watershed of the Moffitt & Williamson Drain.
5. Proposed relocation and reconstruction will not adversely affect other land owners within the drainage shed.
6. Petitioner requests approval of the proposed relocation and reconstruction under IC 36-9-27-52.5.

WHEREFORE, Petitioner requests that an Order issued from the Hamilton County Drainage Board authorizing relocation and reconstruction of the Moffitt & Williamson Drain, in conformance with applicable law and plans and specifications on file with the Hamilton County Surveyor.

Erwin Bruks
Signed
ERVIN BRUKS
Printed

Martin Marietta Materials



Indiana District
11405 North Pennsylvania
Suite 250
Carmel, IN 46032
Telephone (317) 573-4460
Fax (317) 573-5975

January 26, 2009

Mr. Greg Hoyes, Plan Reviewer
Hamilton County Surveyor's Office
One Hamilton County Square, Suite 188
Noblesville, Indiana 46060

Re: Moffitt & Williamson Drain Relocation

Dear Mr. Hoyes:

Enclosed are the following documents regarding the reference project:

- "Petition for Relocation and Reconstruction" for Mueller parcel
- "Non-Enforcement of Drainage Easement for Individual Tracts" for Mueller parcel
- "Petition for Relocation and Reconstruction" for Martin Marietta parcel
- "Non-Enforcement of Drainage Easement for Individual Tracts" for Martin Marietta parcel
- Check No. 00983957 in the amount of \$200 check for the two non-enforcement agreements
- Draft copy of the Maintenance Agreement
- Bond No. 6584849 in the amount of \$655,000 issued by Safeco Insurance Companies

The bond amount was based on the following:

\$435,820	Construction bid
30,000	Riprap estimate
<u>80,000</u>	Seeding estimate
\$545,820	SUBTOTAL

<u>109,164</u>	20% additional
\$654,984	TOTAL

Please contact me if you have any questions regarding this submittal.

Sincerely,

D. Max Williams
Senior Environmental Engineer

Enclosures

BEFORE THE HAMILTON COUNTY DRAINAGE BOARD
IN THE MATTER OF

Moffitt Williamson Drain, Martin Marietta Materials Relocation

NOTICE

To Whom It May Concern and: _____

Notice is hereby given of the hearing of the Hamilton County Drainage Board concerning the reconstruction of the **Moffitt Williamson Drain, Martin Marietta Materials Relocation** on **April 27, 2009**, at **9:00 A.M.** in Commissioners Court, Hamilton County Judicial Center, One Hamilton County Square, Noblesville, Indiana. Construction and maintenance reports of the Surveyor and the Schedule of Assessments proposed by the Drainage Board have been filed and are available for public inspection in the office of the Hamilton County Surveyor.

Hamilton County Drainage Board

Attest: Lynette Mosbaugh

ONE TIME ONLY

STATE OF INDIANA)
) SS BEFORE THE HAMILTON
)
COUNTY OF HAMILTON) DRAINAGE BOARD

IN THE MATTER OF **Moffitt Williamson Drain, Martin Marietta
Materials Relocation**

NOTICE

Notice is hereby given that the Hamilton County Drainage Board at its regular meeting **April 27, 2009** adopted the reconstruction report of the Surveyor and the Amended Schedule of damages and assessments including annual assessment for periodic maintenance, finding that the costs, damages and expense of the proposed improvement would be less than the benefits which will result to the owner of lands benefited thereby.

The Board issued an order declaring the proposed improvement established. Such findings and order were marked filed and are available for inspection in the Office of the Hamilton County Surveyor.

If judicial review of the findings and order of the Board is not requested pursuant to Article VIII of the 1965 Indiana Drainage Code as amended within twenty (20) days from the date of publication of this notice, the findings and order shall become conclusive.

HAMILTON COUNTY DRAINAGE BOARD

BY: Steven C. Dillinger
PRESIDENT

ATTEST: Lynette Mosbaugh
SECRETARY

FINDINGS AND ORDER

CONCERNING THE PARTIAL VACATION OF THE

Moffitt Williamson Drain, Martin Marietta Materials Relocation

**Station 56+31 to Station 80+75 and
Station 80+75 to Station 84+63**

On this 27th day of April 2009, the Hamilton County Drainage Board has held a hearing on the Maintenance Report and Schedule of Assessments of the **Moffitt Williamson Drain, Martin Marietta Materials Relocation, Station 56+31 to Station 80+75 and Station 80+75 to Station 84+63.**

Evidence has been heard. Objections were presented and considered. The Board then adopted an order of action. The Board now finds that the costs of continued maintenance to the portion of the above drain exceed the benefits to the real estate benefited by the portion of the drain to be abandoned and issues this order vacating the above section of the **Moffitt Williamson Drain, Martin Marietta Materials Relocation, Station 56+31 to Station 80+75 and Station 80+75 to Station 84+63.**

HAMILTON COUNTY DRAINAGE BOARD

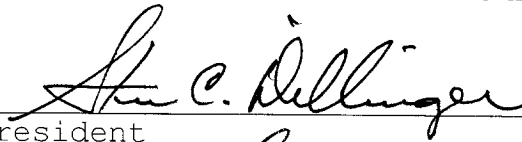

President



Member



Member

Attest: 

STATE OF INDIANA)
) ss:
COUNTY OF HAMILTON)

BEFORE THE HAMILTON COUNTY
DRAINAGE BOARD
NOBLESVILLE, INDIANA

IN THE MATTER OF THE
RECONSTRUCTION OF THE
Moffitt Williamson Drain, Martin Marietta Materials Relocation

FINDINGS AND ORDER FOR RECONSTRUCTION

The matter of the proposed Reconstruction of the **Moffitt Williamson Drain, Martin Marietta Materials Relocation** came before the Hamilton County Drainage Board for hearing on **April 27, 2009**, on the Reconstruction Report consisting of the report and the Schedule of Damages and Assessments. The Board also received and considered the written objection of an owner of certain lands affected by the proposed Reconstruction, said owner being:

Evidence was heard on the Reconstruction Report and on the aforementioned objections.

The Board, having considered the evidence and objections, and, upon motion duly made, seconded and unanimously carried, did find and determine that the costs, damages and expenses of the proposed Reconstruction will be less than the benefits accruing to the owners of all land benefited by the Reconstruction.

The Board having considered the evidence and objections, upon motion duly made, seconded and unanimously carried, did adopt the Schedule of Assessments as proposed, subject to amendment after inspection of the subject drain as it relates to the lands of any owners which may have been erroneously included or omitted from the Schedule of Assessments.

The Board further finds that it has jurisdiction of these proceedings and that all required notices have been duly given or published as required by law.

Wherefore, it is ORDERED, that the proposed Reconstruction of the **Moffitt Williamson Drain, Martin Marietta Materials Relocation** be and is hereby declared established.

Thereafter, the Board made inspection for the purpose of determining whether or not the lands of any owners had been erroneously included or excluded from the Schedule of Assessments. The Board finds on the basis of the reports and findings at this hearing as follows:

HAMILTON COUNTY DRAINAGE BOARD

PRESIDENT

Member

Member

ATTEST:

Executive Secretary

MAINTENANCE AGREEMENT

THIS AGREEMENT entered into this 8th day of May, 2009, by and between MARTIN MATERIALS, INC., of Wake County, State of North Carolina, hereinafter referred to as "Martin Marietta"; and the HAMILTON COUNTY DRAINAGE BOARD, of Hamilton County, State of Indiana, hereinafter referred to as "Drainage Board".

WITNESSETH:

WHEREAS, Martin Marietta operates a sand and gravel plant, limestone quarry and underground mine in Clay Township, Hamilton County, State of Indiana and desires to expand the existing operation;

WHEREAS, Martin Marietta intends to relocate approximately 2650 feet of the existing Moffitt & Williamson Drain (also known as "Blue Woods Creek"), south of 106th Street, west of Hazel Dell Parkway and east of Gray Road, generally as depicted and described in Exhibit A attached hereto, in Clay Township, Hamilton County, State of Indiana, and has received approval for the relocation from the U.S. Army Corps of Engineers, the Indiana Department of Environmental Management and the Indiana Department of Natural Resources (the "Relocated Segment");

WHEREAS, the Relocated Segment is within property owned by Martin Marietta, Parcel No. 17-14-09-00-00-002.00 located at 0 River Avenue and within property leased by Martin Marietta and owned by E. & H. Mueller Development, LLC, Parcel No. 17-14-09-00-00-003.00 located at 5345 East 106th Street (hereinafter collectively referred to as the "Property");

WHEREAS, on April 27, 2009, the Drainage Board, authorized Martin Marietta to maintain and reconstruct the Relocated Segment. The approval of the Drainage Board to relocate the above described Relocated Segment was subject to Martin Marietta accepting the responsibility to maintain the Relocated Segment;

NOW, THEREFORE, in consideration of the sum of \$1.00 paid by Martin Marietta to Hamilton County Drainage Board, the receipt and sufficiency of which is hereby acknowledged, and such further considerations as herein mentioned, the parties hereto, intending to be legally bound, hereby agree as follows:

1. The recitals set forth above are incorporated herein by this reference as if fully restated herein.
2. Martin Marietta shall reconstruct and maintain the Relocated Segment. Maintenance shall consist of removal of obstructions to flow, stabilizing stream banks that are eroding, removal of woody growth within the stream, removal of beaver dams and annual mowing of the easement area of the Moffitt & Williamson Drain across the Property to the extent allowed by applicable laws and regulations. The existing tree rows west and south of the Relocated Segment are not to be removed. These rows start at the beginning of the Relocated Segment at Station 41+10 and

extend to a point approximately 100 feet west of River Road at approximate Station 14+40.

3. Martin Marietta will maintain the Relocated Segment of the Moffitt & Williamson Drain across the Property in accordance with the standards set forth in Ordinance No. 4-26-99-C and in accordance with any other applicable legal requirements.
4. Inspections. The Hamilton County Surveyor or his representative (the "Surveyor") shall have the right to inspect the Relocated Segment. The Surveyor shall contact the Martin Marietta North Indianapolis Plant Manager or his representative at (317) 846-5942 at no less than 48 hours prior to entering the site to assure that he is aware of the safety concerns associated with the nearby mining activities.
5. Termination. Martin Marietta's obligations under this Maintenance Agreement will continue until Martin Marietta ceases its surface mining operations on and completes reclamation on Parcel No. 17-14-09-00-003.00 owned by E. & H. Mueller Development, LLC, and provides notice thereof to the Drainage Board. In the event of and upon the date that the Drainage Board resumes maintenance jurisdiction over that part of the Moffitt & Williamson Drain that is the subject of this Agreement, then this Agreement shall terminate and have no further force or effect, and Martin Marietta shall have no further responsibilities or obligations under this Agreement regarding the maintenance of the subject drain, as long as the Relocated Segment is in the condition of maintenance required in Section 3 above at the time notice is given to the Drainage Board.
6. Notices. Any notice or other communication provided for hereunder will be in writing and may be (i) served by personal delivery, (ii) made by facsimile transmission, or (iii) sent by overnight courier service (with all fees prepaid) to the receiving parties as follows, or to any other address which either party may hereafter designate for itself in writing:

If to Martin Marietta: 11405 North Pennsylvania Street, Suite 250
Carmel, IN 46032
Attn: Vice President-General Manager
Fax: 317-573-5975

With a copy to: Martin Marietta Materials, Inc.
2710 Wycliff Road
Raleigh, NC 27607
Attn: Vice President-General Counsel
Fax: 919-783-4535

If to Drainage Board: One Hamilton County Square
Suite 188
Noblesville, Indiana 46060-2230
Attn: County Surveyor
Fax: 317-776-9628

Any such notice or communication shall be deemed to be given, if delivered in person, on the date delivered, if made by facsimile transmission, on the date transmitted, or, if sent by overnight courier service, on the date sent as evidenced by the bill of lading, and shall be deemed received, if delivered in person, on the date of personal delivery, if made by facsimile transmission, upon confirmation of receipt (including electronic confirmation), or if sent by overnight courier, on the first business day after the day sent.

7. Assignment; Binding Effect. This Agreement shall be binding upon the parties to this Agreement and their respective legal representatives, heirs, devisees, legatees, or other successors and assigns, and shall inure to the benefit of the parties to this Agreement and their respective permitted legal representatives, heirs, devisees, legatees, or other permitted successors and assigns.
8. Interpretation; Captions. Whenever the context so requires, the singular number shall include the plural and the plural shall include the singular, and the gender of any pronoun shall include the other genders. Titles and captions of or in this Agreement are inserted only as a matter of convenience and for reference and in no way affect the scope for this Agreement or the intent of its provisions.
9. Entire Agreement. This Agreement constitutes the entire agreement of the parties to this Agreement with respect to its subject matter, supersedes all prior agreements, if any, of the parties to this Agreement with respect to its subject matter, and may not be amended except in writing signed by the party to this Agreement against whom the change is being asserted.
10. No Waiver. The failure of any party to this Agreement at any time or times to require the performance of any provisions of this Agreement shall in no manner affect the right to enforce the same; and no waiver by any party to this Agreement of any provision (or of a breach of any provision) of this Agreement, whether by conduct or otherwise, in any one or more instances, shall be deemed or construed either as a further or continuing waiver of any such provision or breach or as a waiver of any other provision (or of a breach of any other provision) of this Agreement.
11. Governing Law. This Agreement shall be governed by and construed in accordance with the laws of the State of Indiana, without regard to principles of conflict or choice of law.

12. Counterparts. This Agreement may be executed in two or more copies, each of which shall be deemed an original, and it shall not be necessary in making proof of this Agreement or its terms to produce or account for more than one of such copies.

(Signatures on following page)

IN WITNESS WHEREOF, this Agreement has been duly executed as of the date first above written.

MARTIN MARIETTA:

MARTIN MARIETTA MATERIALS, INC.

By: Edwin P. Gehl
(Signature)

EDWIN P GEHL VP/GM
(Printed name and title) INDIANA DISTRICT

Address: 11405 North Pennsylvania St.
Suite 250
Carmel, IN 46032

DRAINAGE BOARD:

HAMILTON COUNTY DRAINAGE BOARD

Christine Altman
Christine Altman, President

Steven Holt
Steven Holt, Vice President

Donald Silvey
Steven Dillinger, Member
Donald Silvey, Alternate

Address: One Hamilton County Square
Suite 188
Noblesville, Indiana 46060-2230

Fax: 317-776-9628

Attest: Stephanie Mostauf

STATE OF Indiana
COUNTY OF Hancock

I, Paula Conarroe, a Notary Public for and in the aforesaid County and State do hereby certify Edwin P Gehr, VP/GM of Martin Marietta Materials, Inc., personally appeared before me this day and being by me first duly sworn does hereby acknowledge the due execution of the foregoing agreement for the purpose herein expressed.

WITNESS my hand and official seal, this 8 day of May, 2009.

Paula K Conarroe
Notary Public

My Commission Expires: 2-11-15

STATE OF _____
COUNTY OF _____

I, _____, a Notary Public for and in the aforesaid County and State do hereby certify that Christine Altman, Steven Holt and Steven Dillinger of Hamilton County Drainage Board, each personally appeared before me this day and being by me first duly sworn does hereby acknowledge the due execution of the foregoing agreement for the purpose herein expressed.

WITNESS my hand and official seal, this _____ day of _____, 2009.

Notary Public

My Commission Expires: _____

This instrument was prepared by:
Yvonne C. Bailey, Martin Marietta Materials, Inc., 2710 Wycliff Road, Raleigh, NC.

CERTIFICATE OF COMPLETION AND COMPLIANCE

To: Hamilton County Surveyor

Re: **Moffitt & Williamson Drain Relocation**
Permit No. INDNE-2009-00006

I hereby certify that:

1. I am a Registered Land Surveyor or Engineer in the State of Indiana.
2. I am familiar with the plans and specifications for the above referenced subdivision.
3. I have personally observed and supervised the completion of the drainage facilities for the above referenced subdivision.
4. The drainage facilities within the above referenced subdivision to the best of my knowledge, information and belief have been installed and completed in conformity with all plans and specifications.
5. The drainage facilities within the above referenced subdivision to the best of my knowledge, information and belief have been correctly represented on the Record Drawings, Digital Record Drawings and the Structure Data Spreadsheet.

Signature: Darrell Max Williams Date: December 9, 2009

Type or Print Name: Darrell Max Williams

Business Address: Martin Marietta Materials, Inc.

11405 North Pennsylvania Street, Suite 250, Carmel, IN 46032

Telephone Number: 317-428-5220

SEAL

INDIANA REGISTRATION NUMBER

60016245

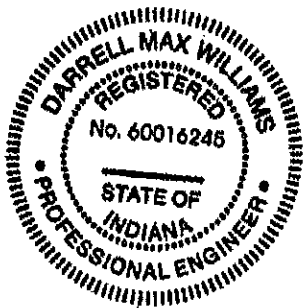



Kenton C. Ward, CFM
Surveyor of Hamilton County
Phone (317) 776-8495
Fax (317) 776-9628

Suite 188
One Hamilton County Square
Noblesville, Indiana 46060-2230

To: Hamilton County Drainage Board

March 8, 2010

Re: Moffitt-Williamson Drain: Martin Marietta Materials Relocation

Attached are as-builts, certificate of completion & compliance, and other information for Martin Marietta Materials Relocation. An inspection of the drainage facilities for this section has been made and the facilities were found to be complete and acceptable.

During construction, changes there were no significant changes made to the drainage plans submitted with my report for this drain dated February 3, 2009 . The report was approved by the Board at the hearing held April 27, 2009. (See Drainage Board Minutes Book 12, Pages 1-4) Therefore, the length of the drain remains at **4,110feet**. There was 2832 feet of original drain removed with this project. Therefore, 1278 feet of drain was added to the watershed's overall length.

The non-enforcements were approved by the Board at its meeting on April 27, 2009 and recorded under instrument #'s 2009023876 and 2009023877. The following sureties were guaranteed by SAFECO Insurance Company of America and released by the Board on its December 23, 2009 meeting.

Bond-LC No: 6584849
Insured For: Storm Sewers
Amount: \$655,000.00
Issue Date: January 21, 2009

I recommend the Board approve the drain's construction as complete and acceptable.

Sincerely,

Kenton C. Ward, CFM
Hamilton County Surveyor

KCW/slm

CONSTRUCTION PLANS FOR RELOCATION OF BLUE WOODS CREEK HAMILTON COUNTY, INDIANA

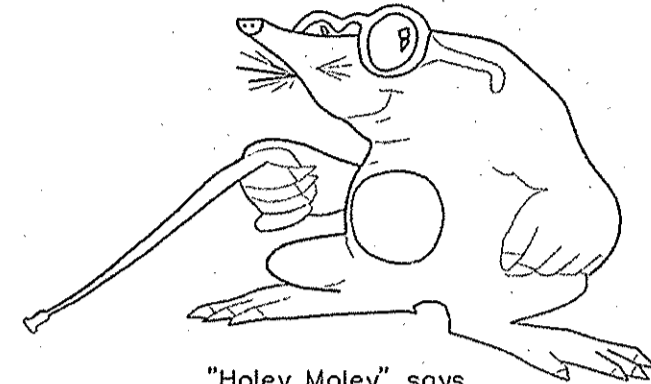

"Holey Moley" says,
"DON'T DIG BLIND!"
Call Monday through Friday 7 AM to 6 PM
1-800-392-5544 428-5200
Within Indiana Outside Indiana
PER INDIANA STATE LAW IS-69-1991, IT IS AGAINST THE LAW TO EXCAVATE WITHOUT NOTIFYING THE UNDERGROUND LOCATION SERVICE TWO (2) WORKING DAYS BEFORE COMMENCING WORK.

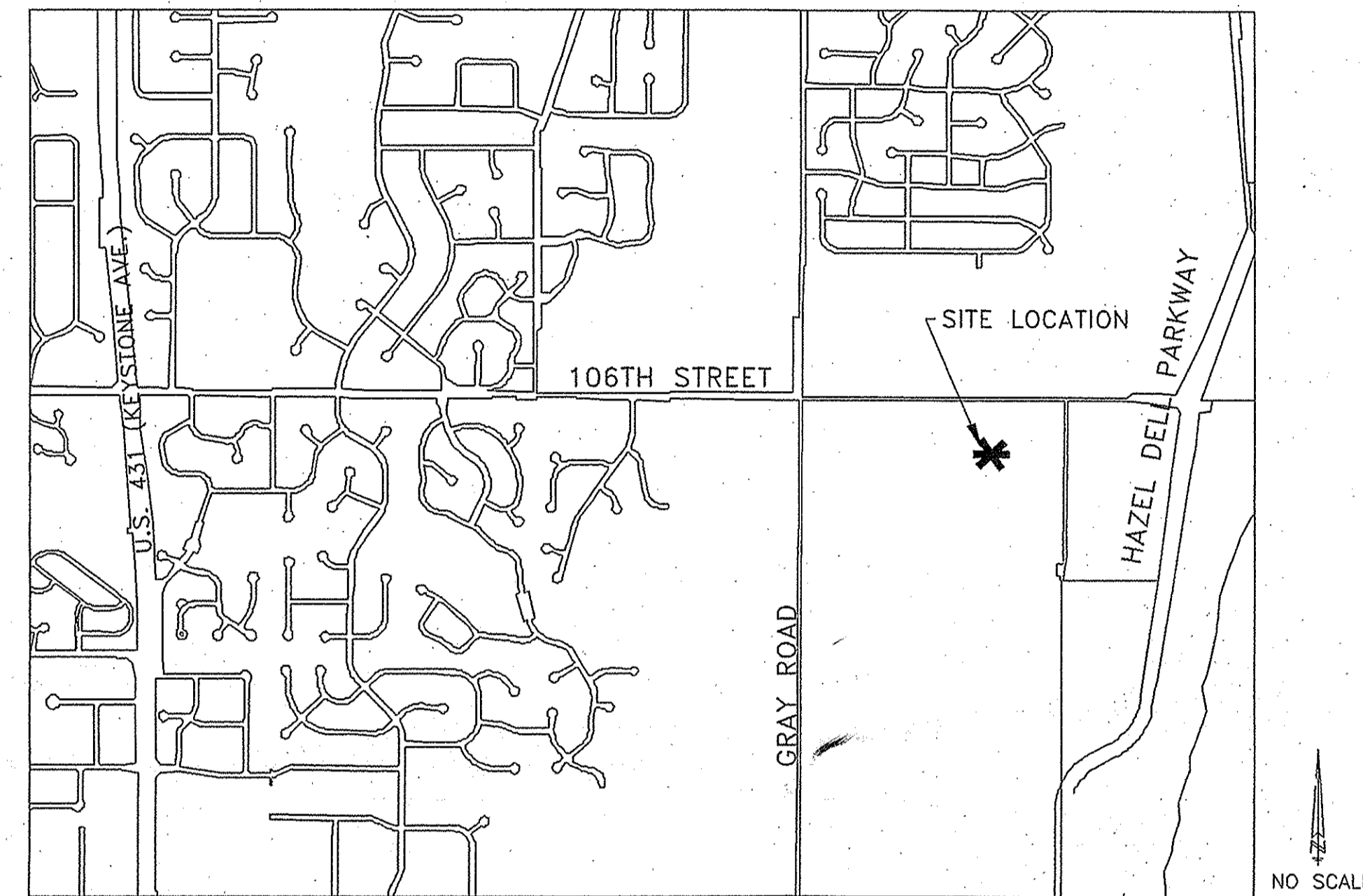

SITE LOCATION MAP

General Notes

THE WORK COVERED BY THIS SPECIFICATION CONSISTS OF FURNISHING ALL LABOR AND EQUIPMENT AND PERFORMING ALL OTHER OPERATIONS IN CONNECTION WITH THE CONSTRUCTION OF THE PROPOSED CHANNEL AND BANKS. WORK SHALL BE PERFORMED BETWEEN STATIONING 0+00 AND 41+10.00 OR .78 MILES.

IT IS THE RESPONSIBILITY OF EACH CONTRACTOR TO VERIFY ALL EXISTING UTILITIES AND CONDITIONS PERTAINING TO HIS PHASE OF THE WORK. IT SHALL BE THE CONTRACTORS RESPONSIBILITY TO CONTACT THE OWNERS OF THE VARIOUS UTILITIES BEFORE WORK IS STARTED. THE CONTRACTOR SHALL NOTIFY IN WRITING THE OWNERS OR THE ENGINEER OF ANY CHANGES, ERRORS OR OMISSIONS FOUND ON THESE PLANS OR IN THE FIELD BEFORE WORK IS STARTED OR RESUMED.

STANDARD SPECIFICATIONS OF THE HAMILTON COUNTY SURVEYOR'S OFFICE SHALL APPLY FOR ALL WORK AND MATERIAL.

THE CONTRACTOR SHALL BE RESPONSIBLE FOR OBTAINING ALL STATE, CITY AND COUNTY PERMITS.

CONTRACTOR SHALL CHECK WITH THE ENGINEER PRIOR TO THE START OF CONSTRUCTION TO VERIFY DATE OF PLANS.

ALL CONTRACTORS SHALL VERIFY SUBSURFACE CONDITIONS PRIOR TO BIDDING.

UNDERGROUND TILES NOT VISIBLE ON THE SURFACE MAY EXIST. ANY TILES ENCOUNTERED DURING CONSTRUCTION SHALL BE MAINTAINED WITH POSITIVE DRAINAGE.

A TEMPORARY SEEDING MIXTURE IN THE AREAS WHERE STRIPPING OF FILLS HAVE BEEN GRADED, SHALL BE SEED FOR SILT AND EROSION PROTECTION. AFTER GRADING, ALL CONSTRUCTION AREAS ARE TO BE SEED AS FOLLOWS:

- A. SWALE SEEDING: SEED AND FERTILIZE WITHIN CONSTRUCTION LIMITS WITH 5#/ACRE "REDTOP" GRASS, 20#/ACRE "RYE GRASS," 20#/ACRE "BLUEGRASS," 25#/ACRE "FESCUE" AND 600#/ACRE 12-12-12 FERTILIZER.
 - B. CUT/FILL SEEDING SEED AND FERTILIZE WITH 25#/ACRE "FESCUE," 20#/ACRE "RYE GRASS," 15#/ACRE "BLUEGRASS" AND 12-12-12 FERTILIZER.
 - C. SEEDED AREAS SHALL HAVE A SUITABLE MULCH APPLIED FOR EROSION AND SILT CONTROL. MULCH MAY BE STRAW, SHREDDED HARDWOOD OR EROSION CONTROL MAT.
 - D. DEVELOPERS OPTION: CONSTRUCTION AREAS REQUIRING EROSION CONTROL MAY BE HYDROSEEDING IN ACCORDANCE WITH ABOVE SEED AND FERTILIZER SPECIFICATIONS.
- ALL PIPES OR DRAINAGE STRUCTURES IN TRENCHES UNDER PAVED SURFACES SHALL BE BACKFILLED WITH GRANULAR MATERIAL AND COMPACTED BY APPROVED METHODS.

CORRUGATED METAL PIPE SHALL CONFORM TO AASHO DESIGNATION M-36 16 GAUGE UNLESS OTHERWISE NOTED.

REINFORCED CONCRETE PIPE SHALL BE CLASS III.

IDEM NO:
2001-284-29-LPR-A
INR109995 (RULE 5)

IDNR NO:
FW-21136

COE NO:
200500098-jea
(Previously 200100258-bkc)

CITY OF CARMEL
PERMIT NO.: 165

HAMILTON COUNTY SURVEYOR
PERMIT NO.: INDNE-2009-00006

RECORD DRAWING

CREEK RELOCATION AS-BUILTS
DECEMBER 7, 2009

Patrick C. Sheehan
PATRICK C. SHEEHAN P.E. 19500338



REVISIONS		
SHEET	DESCRIPTION	DATE
3	ADDITION OF MOUND & DITCH TOPO	11/28/00
ALL	REVISIONS TO ALL SHEETS	1/23/01
ALL	MINOR REVISIONS TO ALL SHEETS	3/7/01
ALL	CHANNEL CROSS SECTION MODIFIED	1/8/02
ALL	GENERAL REVISIONS	6/28/02
ALL	AS-BUILTS	12/7/09

SHEET INDEX	
SH.NO.	DESCRIPTION
1	Title Sheet
2	Existing Conditions (Scale 1" = 200')
3	Existing Conditions (Scale 1" = 100')
4-6	Ditch Reconstruction Plan & Profile
7-9	Cross-section Plan Sheet
10	Detail & Specification Sheet
11	Erosion Control Sheet

PREPARED FOR:

ORIGINAL ADDRESS:
MARTIN MARIETTA MATERIALS, INC.
1980 E. 116TH STREET, SUITE 200
CARMEL, IN 46032
TELEPHONE: (317) 573-4460
FAX: (317) 573-5975
ATTN: D. MAX WILLIAMS

CURRENT ADDRESS
MARTIN MARIETTA MATERIALS, INC.
11405 N. PENNSYLVANIA ST., STE 250
CARMEL, IN 46032
TELEPHONE: (317) 573-4460
FAX: (317) 573-5975
ATTN: D. MAX WILLIAMS

PREPARED BY:

WEIHE ENGINEERS INC.
10505 NORTH COLLEGE AVENUE
INDIANAPOLIS, INDIANA 46280
TELEPHONE: (317) 846-6611
FAX: (317) 843-0546

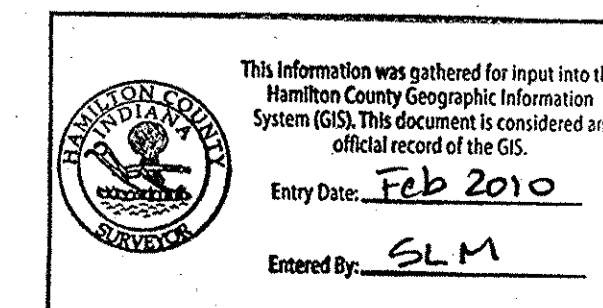

WEIHE ENGINEERS, INC.
10505 NORTH COLLEGE AVENUE
INDIANAPOLIS, INDIANA 46280
(317) 846-6611 FAX: (317) 843-0546
TOLL-FREE (800) 452-0406
CIVIL ENGINEERS • LAND SURVEYORS • LAND PLANNERS • LANDSCAPE ARCHITECTS
ALAN H. WEIHE, P.E., U.S. PRESIDENT

PROJECT NO.	DATE
DWG NAME	BY
COORDINATING	BY
FIELD BY	BY
DRAWN BY	BY
CHECKED BY	DATE
JOB	1/10/09

REVISIONS
ADDITION OF MOUND & DITCH TOPO
REVISIONS TO ALL SHEETS
MINOR REVISIONS TO ALL SHEETS
CHANNEL CROSS SECTIONS MODIFIED
GENERAL REVISIONS
AS-BUILT SUBMITTAL

PREPARED FOR:
BLUE WOODS CREEK RELOCATION
(MOFFIT WILLIAMSON LEGAL DRAIN)
MARTIN MARIETTA MATERIALS, INC.

TITLE SHEET
Part of the 4 1/2' of Sec. 9, T7N-R6E, S 28 of Sec. 4-T7N-R6E, Gray Twp., Hamilton Co., Indiana

SHEET NO.
1

PROJECT NO.
W00-0285

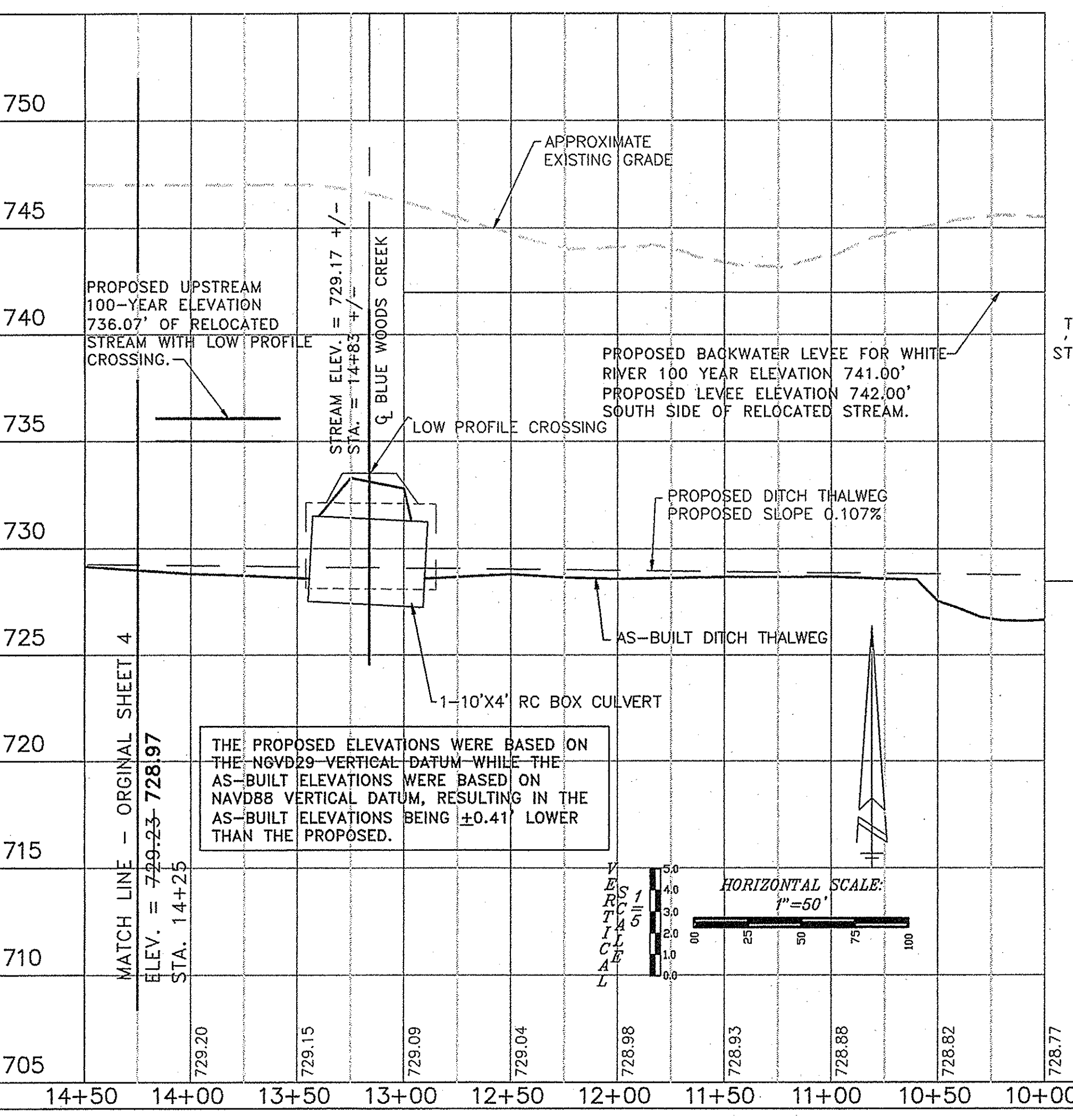
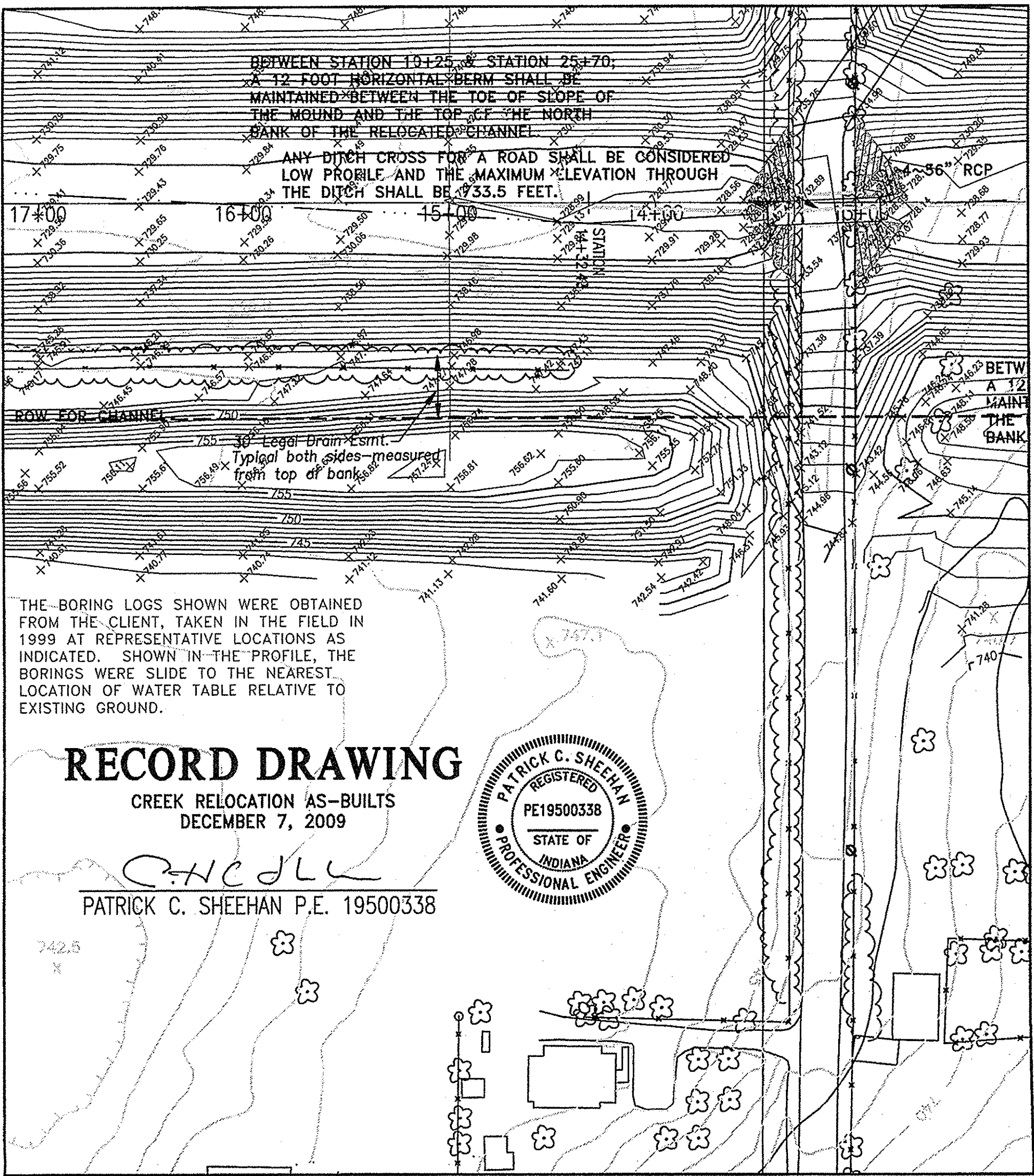

BOX CULVERT
 THE PRE-CAST CONCRETE 10' SPAN X 4' RISE BOX CULVERT SHALL BE MADE IN ACCORDANCE WITH ASTM-C1433 REGARDING DIMENSIONS, MATERIAL AND DESIGN METHODS. THE DESIGN LIVE LOAD SHALL BE BASED ON AN AASHTO HS-25 TRUCK. PRIOR TO BOX CULVERT MANUFACTURE, THE CONTRACTOR SHALL SUBMIT SHOP FABRICATION DRAWINGS OF THE BOX CULVERT SECTIONS TO THE ENGINEER INCLUDING STEEL DESIGN STAMPED BY A PROFESSIONAL ENGINEER REGISTERED IN THE STATE OF INDIANA AND PROPOSED LAY LENGTHS.
 THE PRECAST BOX CULVERT JOINTS SHALL BE INSTALLED IN ACCORDANCE TO INDOT SPECIFICATION 906.06 AND STANDARD E714-BCJT. THE LOW PROFILE ROAD AND CULVERT SHALL BE INSPECTED MONTHLY OR AFTER A RAIN WHEN THE LOW PROFILE STRUCTURE IS TOPPED. IT SHALL BE INSPECTED FOR STRUCTURAL STABILITY AND EROSION.

RIP-RAP SPECIFICATION #1 --- DEPTH 18 INCHES TOTAL --- DEPTH 2 INCHES #8 STONE ON 16 INCH RIPRAP
 RIP-RAP PLACED ON THE INGRESS AND EGRESS ROAD OF THE LOW PROFILE CROSSING WITH ROAD SURFACE STONE
 1. RIP-RAP SHALL BE PLACED ON A FILTER FABRIC (POLYFELT T5700 OR EQUIVALENT) WITH THE SURFACES SUCH THAT THE FLAT PORTION OF THE RIP-RAP CONFORMS TO THE ELEVATIONS (BETWEEN STATIONS AS INDICATED ON THE PLANS) IT SHALL BE SECURELY BEDDED WITH LARGER ROCKS FIRMLY IN CONTACT OF ONE TO ANOTHER. SPACES BETWEEN THE LARGER ROCKS SHALL BE FILLED WITH SMALLER ROCKS AND SPALLS. SMALLER ROCKS SHALL NOT BE GROUTED AS A SUBSTITUTE FOR LARGER ROCKS. ROCK MATERIAL FOR THE RIPRAP SHALL BE WITHIN THE LIMITS AS INDICATED:
 A. NO INDIVIDUAL PIECE WEIGHS MORE THAN 120 POUNDS.
 B. 90 TO 100 PERCENT OF THE MATERIAL PASSES A 12 INCH SIEVE,
 C. 20 TO 60 PERCENT OF THE MATERIAL PASSES A 8 INCH SIEVE,
 D. NOT MORE THAN 10 PERCENT OF THE MATERIAL PASSES A 2 1/2 INCH SIEVE.
 E. A TWO INCH LAYER OF #8 OR #53 STONE SHALL BE ADDED ON TOP OF THE RIP-RAP TO PROVIDE A SMOOTH RIDING SURFACE.
 REASONABLE CARE SHALL BE TAKEN IN LOADING A SIMILAR GRADATION FOR CONSECUTIVE LOADS.

RIP-RAP SPECIFICATION #2 --- DEPTH 14 INCHES
 RIP-RAP UPSTREAM AND DOWNSTREAM FACE OF LOW PROFILE CROSSING
 1. RIP-RAP SHALL BE PLACED ON A FILTER FABRIC (POLYFELT T5700 OR EQUIVALENT) WITH THE SURFACES SUCH THAT THE FLAT PORTION OF THE RIP-RAP CONFORMS TO THE ELEVATIONS (BETWEEN STATIONS AS INDICATED ON THE PLANS) IT SHALL BE SECURELY BEDDED WITH LARGER ROCKS FIRMLY IN CONTACT OF ONE TO ANOTHER. SPACES BETWEEN THE LARGER ROCKS SHALL BE FILLED WITH SMALLER ROCKS AND SPALLS. SMALLER ROCKS SHALL NOT BE GROUTED AS A SUBSTITUTE FOR LARGER ROCKS. ROCK MATERIAL FOR THE RIPRAP SHALL BE WITHIN THE LIMITS AS INDICATED:
 A. NO INDIVIDUAL PIECE WEIGHS MORE THAN 120 POUNDS.
 B. 90 TO 100 PERCENT OF THE MATERIAL PASSES A 12 INCH SIEVE,
 C. 20 TO 60 PERCENT OF THE MATERIAL PASSES A 8 INCH SIEVE,
 D. NOT MORE THAN 10 PERCENT OF THE MATERIAL PASSES A 2 1/2 INCH SIEVE.
 E. A TWO INCH LAYER OF #8 OR #53 STONE SHALL BE ADDED ON TOP OF THE RIP-RAP TO PROVIDE A SMOOTH RIDING SURFACE.
 REASONABLE CARE SHALL BE TAKEN IN LOADING A SIMILAR GRADATION FOR CONSECUTIVE LOADS.

RIP-RAP SPECIFICATION #3 --- DEPTH 18 INCHES TOTAL --- DEPTH 2 INCHES #8 STONE ON 16 INCH RIPRAP
 RIP-RAP PLACED ON THE INGRESS AND EGRESS ROAD.
 1. RIP-RAP SHALL BE PLACED ON A FILTER FABRIC (POLYFELT T5700 OR EQUIVALENT) WITH THE SURFACES SUCH THAT THE FLAT PORTION OF THE RIP-RAP CONFORMS TO THE ELEVATIONS (BETWEEN STATIONS AS INDICATED ON THE PLANS) IT SHALL BE SECURELY BEDDED WITH LARGER ROCKS FIRMLY IN CONTACT OF ONE TO ANOTHER. SPACES BETWEEN THE LARGER ROCKS SHALL BE FILLED WITH SMALLER ROCKS AND SPALLS. SMALLER ROCKS SHALL NOT BE GROUTED AS A SUBSTITUTE FOR LARGER ROCKS. ROCK MATERIAL FOR THE RIPRAP SHALL BE WITHIN THE LIMITS AS INDICATED:
 A. NO INDIVIDUAL PIECE WEIGHS MORE THAN 120 POUNDS.
 B. 90 TO 100 PERCENT OF THE MATERIAL PASSES A 12 INCH SIEVE,
 C. 20 TO 60 PERCENT OF THE MATERIAL PASSES A 8 INCH SIEVE,
 D. NOT MORE THAN 10 PERCENT OF THE MATERIAL PASSES A 2 1/2 INCH SIEVE.
 E. A TWO INCH LAYER OF #8 OR #53 STONE SHALL BE ADDED ON TOP OF THE RIP-RAP TO PROVIDE A SMOOTH RIDING SURFACE.
 REASONABLE CARE SHALL BE TAKEN IN LOADING A SIMILAR GRADATION FOR CONSECUTIVE LOADS.

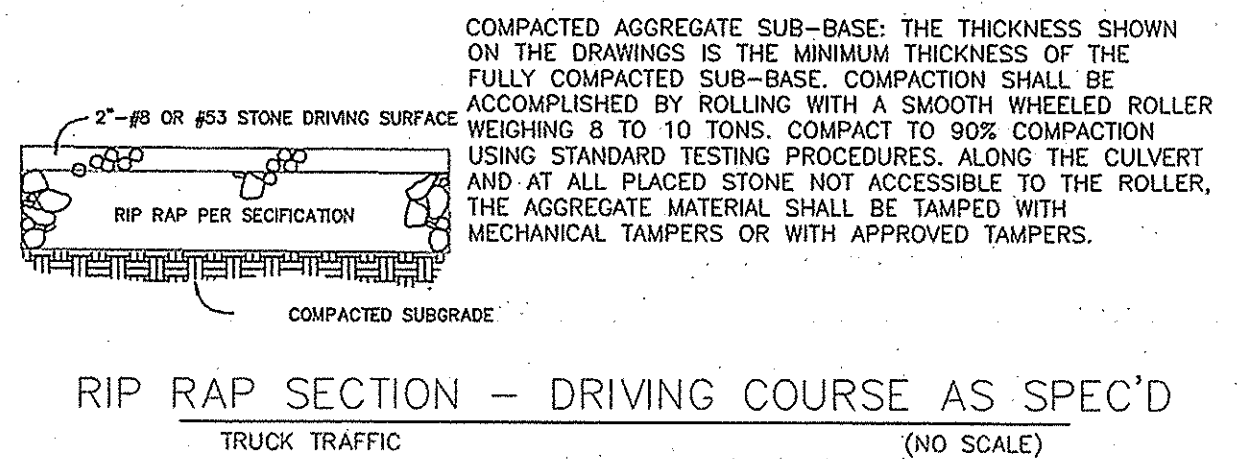
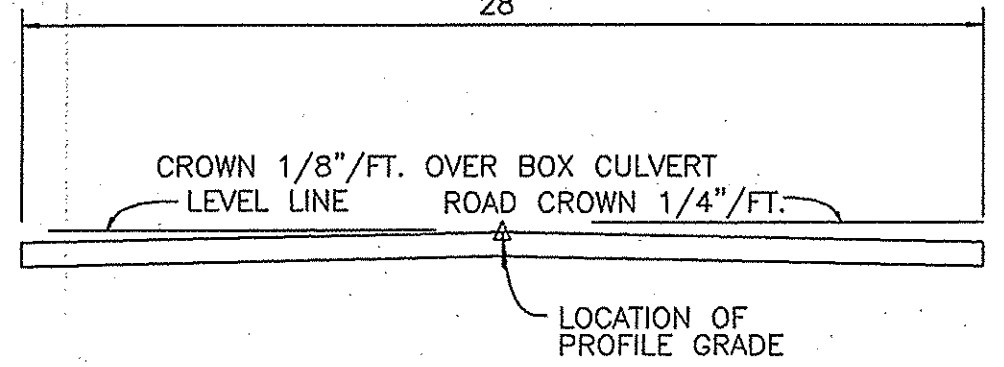

TYPICAL SECTION OF ROAD ON PROFILE CROSSING (NO SCALE)

ANY EROSION THAT OCCURS THROUGH THE STRAIGHT SECTIONS OF THE RELOCATED DITCH; SHALL BE REJUVENATED AND RESTORED TO PLAN GRADE BY THE CURRENT LEASEE (MARTIN MARIETTA MATERIALS, INC.)

TYPICAL X-SECTION OF STREAM CROSSING (Not to Scale)

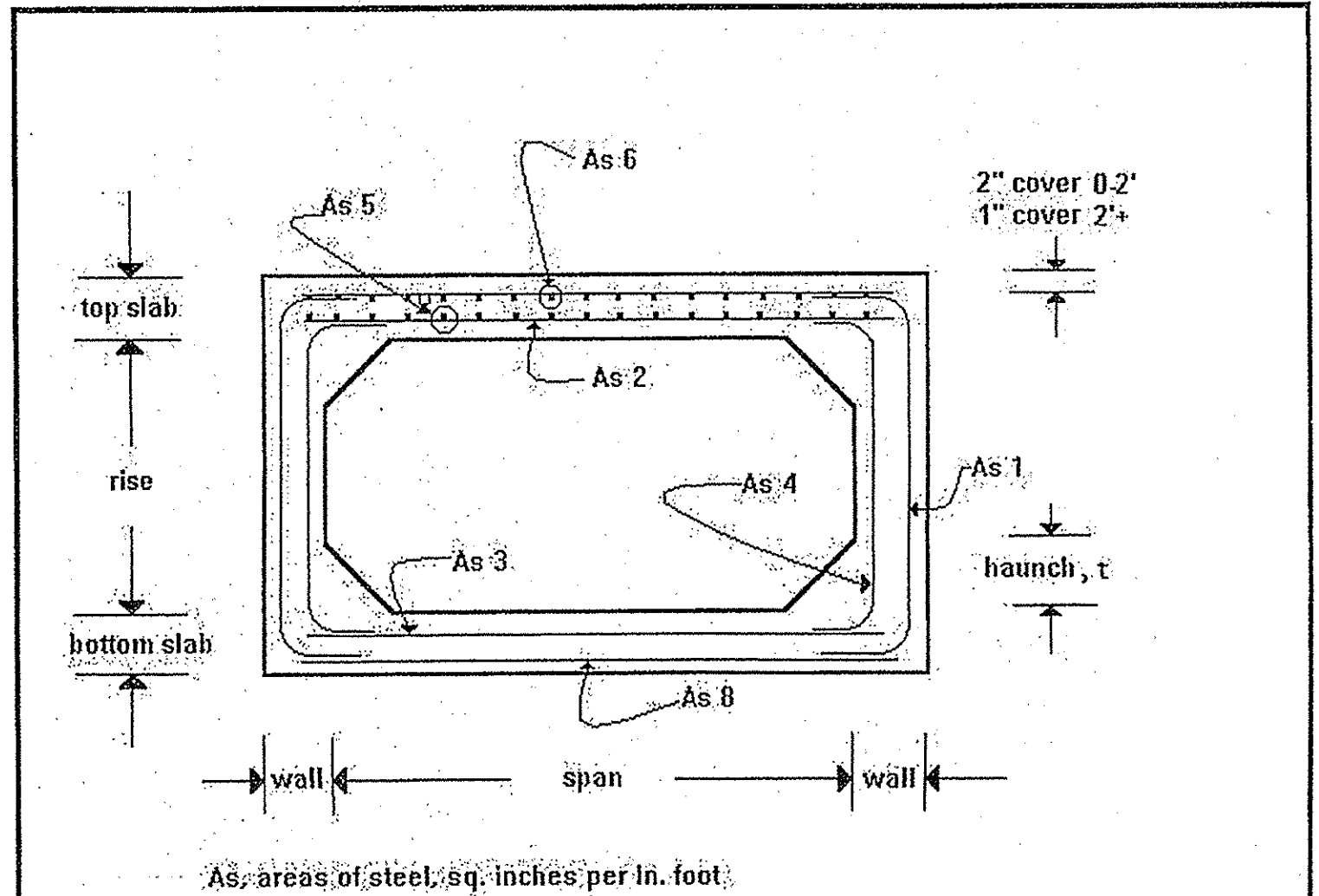
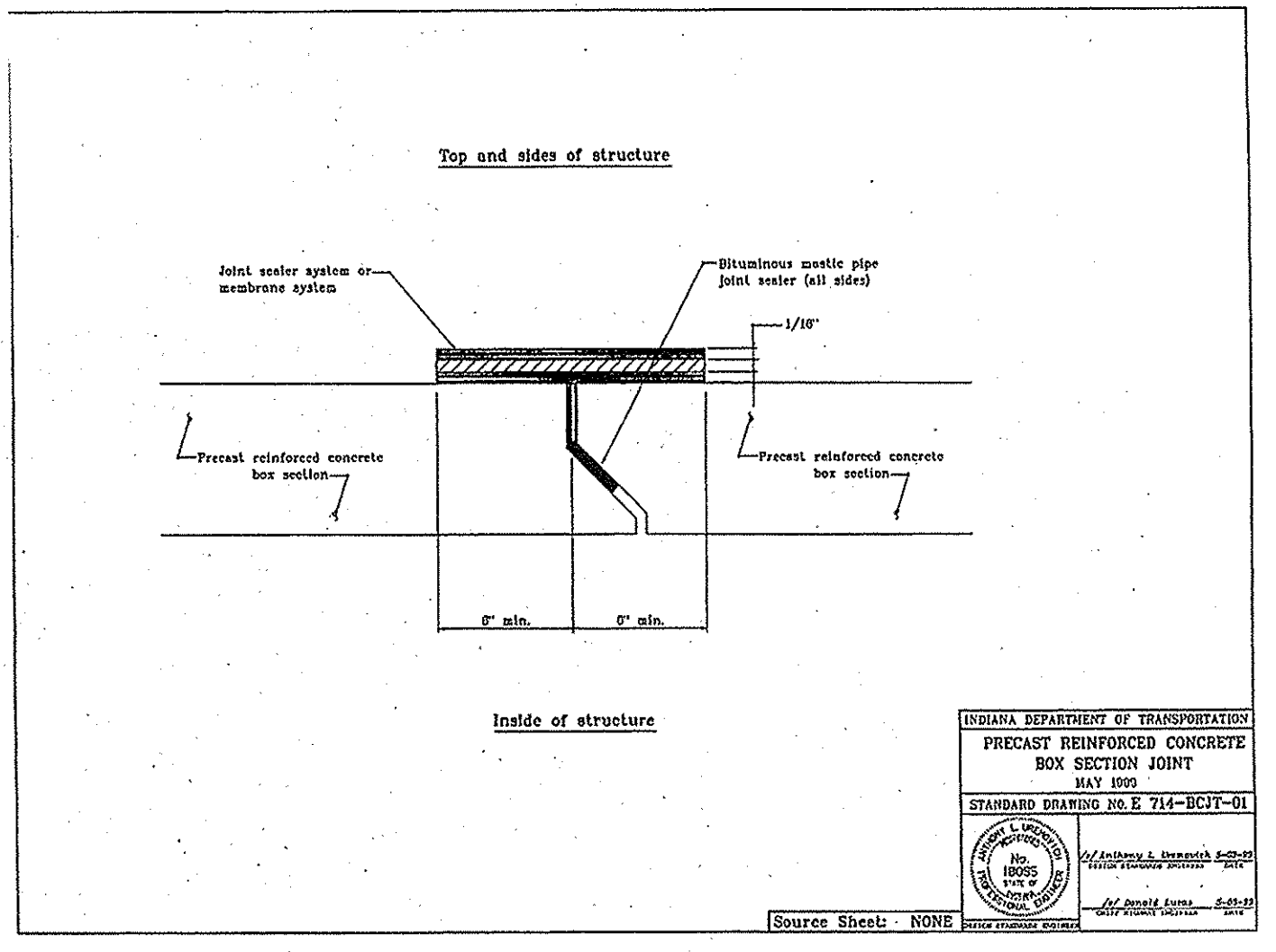
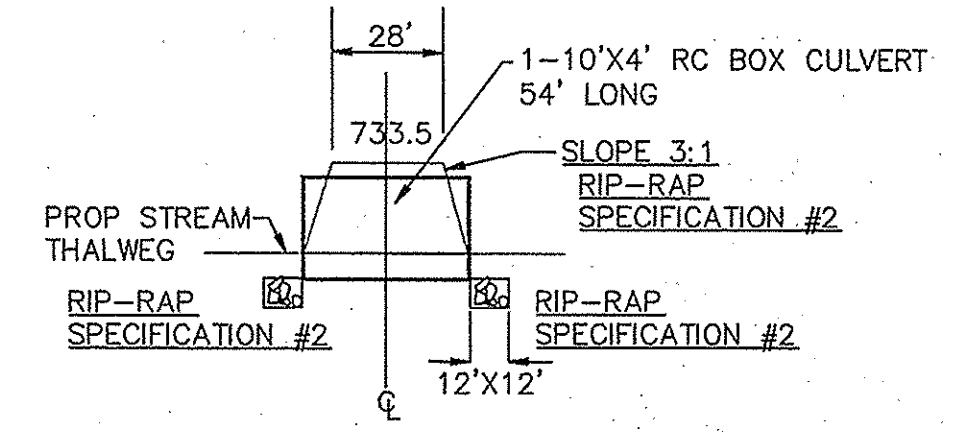

NOTES: 1. BOX CULVERT TO BE MANUFACTURED IN ACCORDANCE TO ASTM C1433, T2, 0-2' COVER
 2. Fy = 65,000 PSI MIN., F'c = 5000 PSI MIN.
 3. LAY LENGTH IS 6 FEET PER SECTION
 4. FOUR (4) BURKE LIFT INSERTS INTO TOP SLAB FOR HANDLING
 5. SPANS GREATER THAN 6', TOP & BOTTOM SLAB IS EQUAL TO WALL THICKNESS

SPAN/RISE (FT)	WALL (IN)	W.T. (LB/FT)	As1	As2	As3	As4	As5	As6	As7	As8
10 x 4	10	4380	0.38	0.48	0.29	0.24	0.24	0.24	0.24	0.24

INDEPENDENT CONCRETE PIPE CORPORATION
 INDIANAPOLIS OFFICE
 2050 HARDING STREET
 PHONE 317/262-4920
 FAX 317/262-4926

STEEL & DIMENSIONAL DETAIL
 BOX CULVERT ASTM C1433 TABLE 2
 IAA WEST PERIMETER RD
 FOX CONTRACTORS, INC.

DATE: 4/28/06
 SCALE: N.T.S.
 NUMBER: 1/1

NOTE: THIS SHEET IS ADDITIONAL INFORMATION RELATIVE TO THE LOW PROFILE CROSSING PROPOSED ACROSS THE PROPOSED RELOCATION OF BLUE WOODS CREEK. THIS SHEET IS IN ADDITION TO THE CONSTRUCTION PLANS PREPARED 11/10/00; REVISED 06/28/02, ENTITLED "BLUE WOODS CREEK RELOCATION". THIS SHEET IS NUMBER 1 AS A SUPPLEMENT TO SHEET 4 OF THE ORIGINAL CONSTRUCTION PLANS.

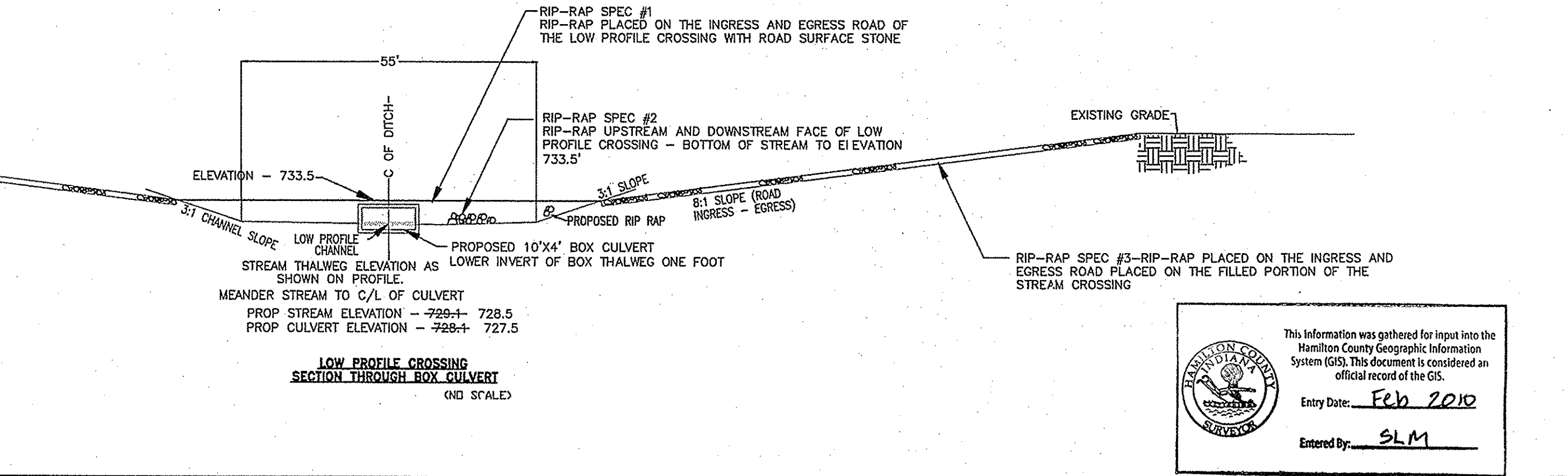

This information was gathered for input into the Hamilton County Geographic Information System (GIS). This document is considered an official record of the GIS.
 Entry Date: Feb 2010
 Entered By: SLM

10505 N. College Avenue
 Indianapolis, Indiana 46280
 weithe.net
 317 | 846 - 6611
 800 | 452 - 6408
 317 | 843 - 0546/fax
 ALLAN H. WEIHE, P.E., P.L.S. - PRESIDENT

WEIHE ENGINEERS
 Land Surveying/Civil Engineering
 Landscape Architecture

PROJECT NO.: W07-0577
 DATE: 10/10/05
 REVISIONS AND ISSUES: REVISED SPEC #1 & 2 Stone Spec

PREPARED FOR:
BLUE WOODS CREEK RELOCATION
 (MOFFIT WILLIAMSON LEGAL DRAIN)
 MARTIN MARIETTA MATERIALS, INC.
 LOW PROFILE CROSSING PLAN SHEET W/ DETAIL
 Part of the R/R of Sec. 8-177N-50E & S/2 of Sec. 4-177N-50E, Clay Twp., Hamilton Co., Indiana
 SHEET NO. 1-(4A)
 PROJECT NO. W07-0577

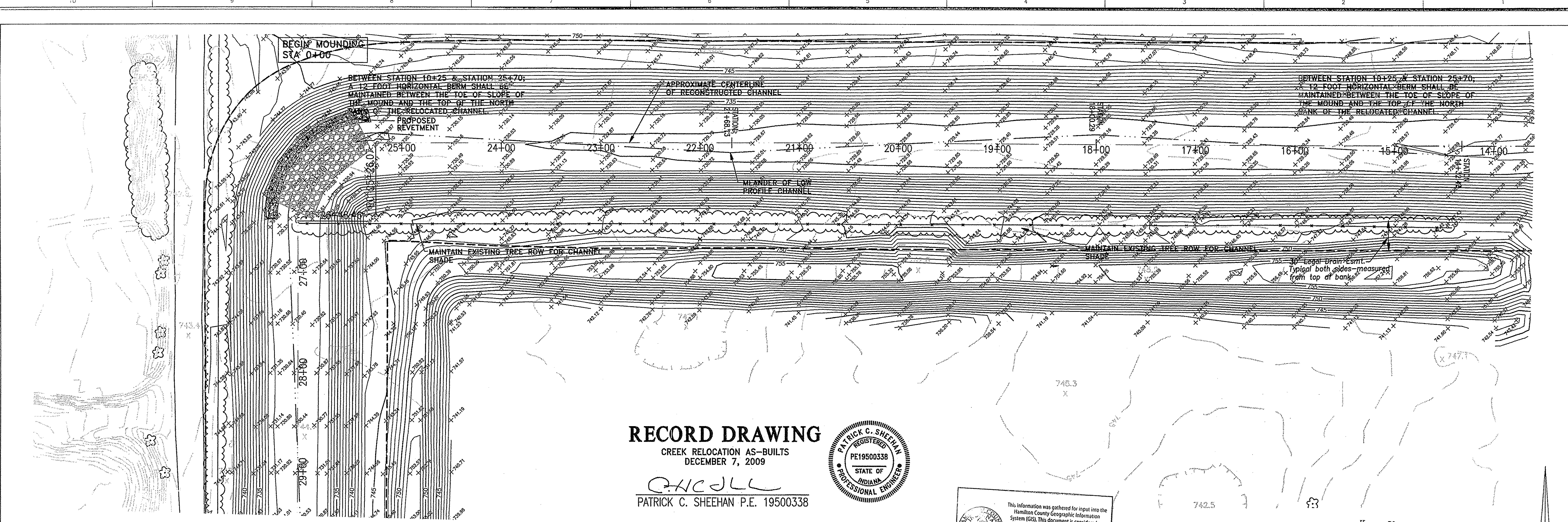

RECORD DRAWING
 CREEK RELOCATION AS-BUILTS
 DECEMBER 7, 2009

QCROLL
 PATRICK C. SHEEHAN P.E. 19500338

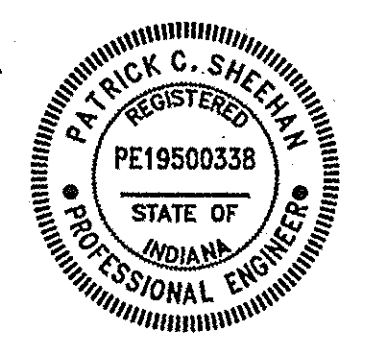

This information was gathered for input into the Hamilton County Geographic Information System (GIS). This document is considered an official record of the GIS.
 Entry Date: Feb 2010
 Entered by: SLM

ANY EROSION THAT OCCURS THROUGH THE STRAIGHT SECTIONS OF THE RELOCATED DITCH; SHALL BE REJUVENATED AND RESTORED TO PLAN GRADE BY THE CURRENT LEASEE (MARTIN MARIETTA MATERIALS, INC.)

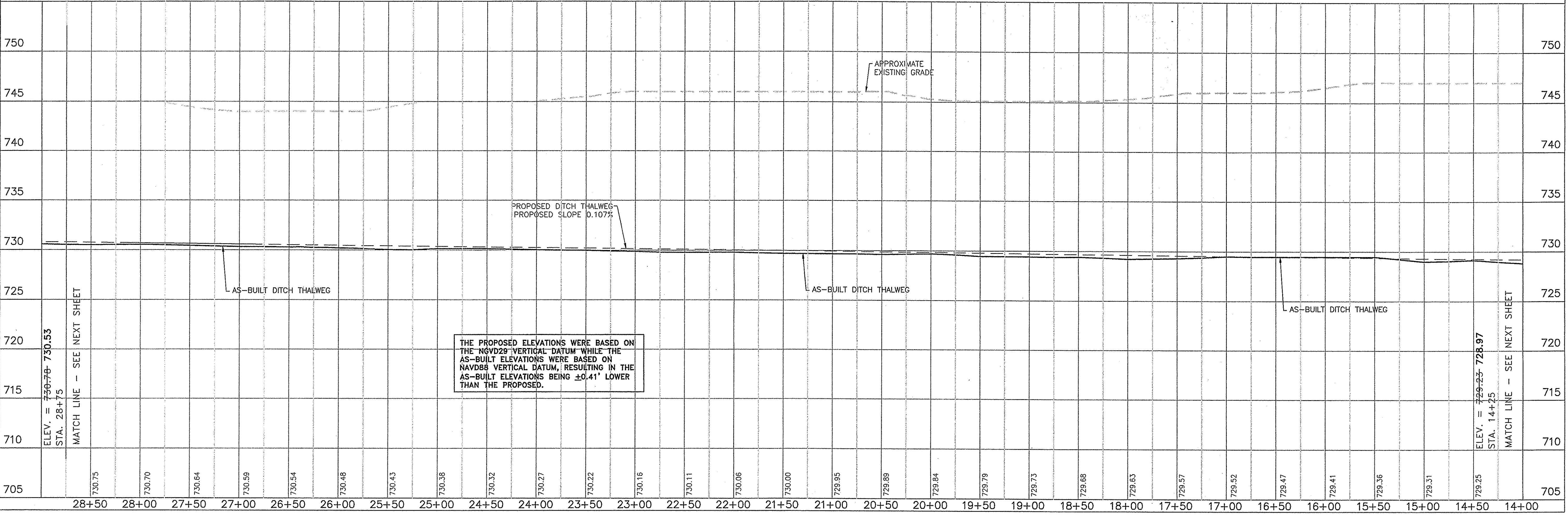
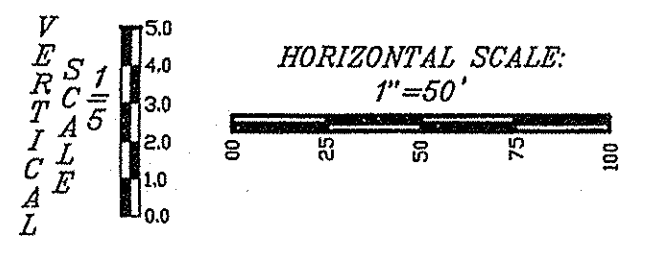

THE PROPOSED ELEVATIONS WERE BASED ON THE NGVD29 VERTICAL DATUM WHILE THE AS-BUILT ELEVATIONS WERE BASED ON NAVD88 VERTICAL DATUM, RESULTING IN THE AS-BUILT ELEVATIONS BEING ±0.41' LOWER THAN THE PROPOSED.

WEIHE ENGINEERS, INC.
 ALLAN H. WEIHE, P.E., L.S. PRESIDENT
 10605 NORTH COLLEGE AVENUE
 INDIANAPOLIS, IN 46240-3030
 (317) 846-0611 FAX (317) 846-0646
 TOLL-FREE (800) 452-8408

CIVIL ENGINEERS • LAND SURVEYORS • LAND PLANNERS • LANDSCAPE ARCHITECTS

PROJECT NO.: W00-0285	DATE: 11/10/00
DWG. NAME: DRAINAGE	DATE: 1/23/01
FIELD BY: EAC	DATE: 1/27/01
DRAWN BY: EAC	DATE: 1/28/02
CHECKED BY: EAC	DATE: 6/25/02
DATE: 12/7/09	

REVISIONS

NO.	DATE	DESCRIPTION
1	1/23/01	REVISIONS TO ALL SHEETS
2	1/27/01	CHANGE REVISIONS TO ALL SHEETS
3	1/28/02	CHANNEL CROSS SECTIONS MODIFIED
4	6/25/02	GENERAL REVISIONS
5	12/7/09	AS-BUILT SUBMITTAL

PREPARED FOR:
BLUE WOODS CREEK RELOCATION
 (MOFFIT WILLIAMSON LEGAL DRAIN)
 MARTIN MARIETTA MATERIALS, INC.
 STREAM PLAN & PROFILE SHEET

Part of the W/2 of Sec. 9-T19N-R6E & S/2 of Sec. 4-T19N-R6E; City Twp., Hamilton Co., Indiana

SHEET NO. **5**

PROJECT NO. **W00-0285**

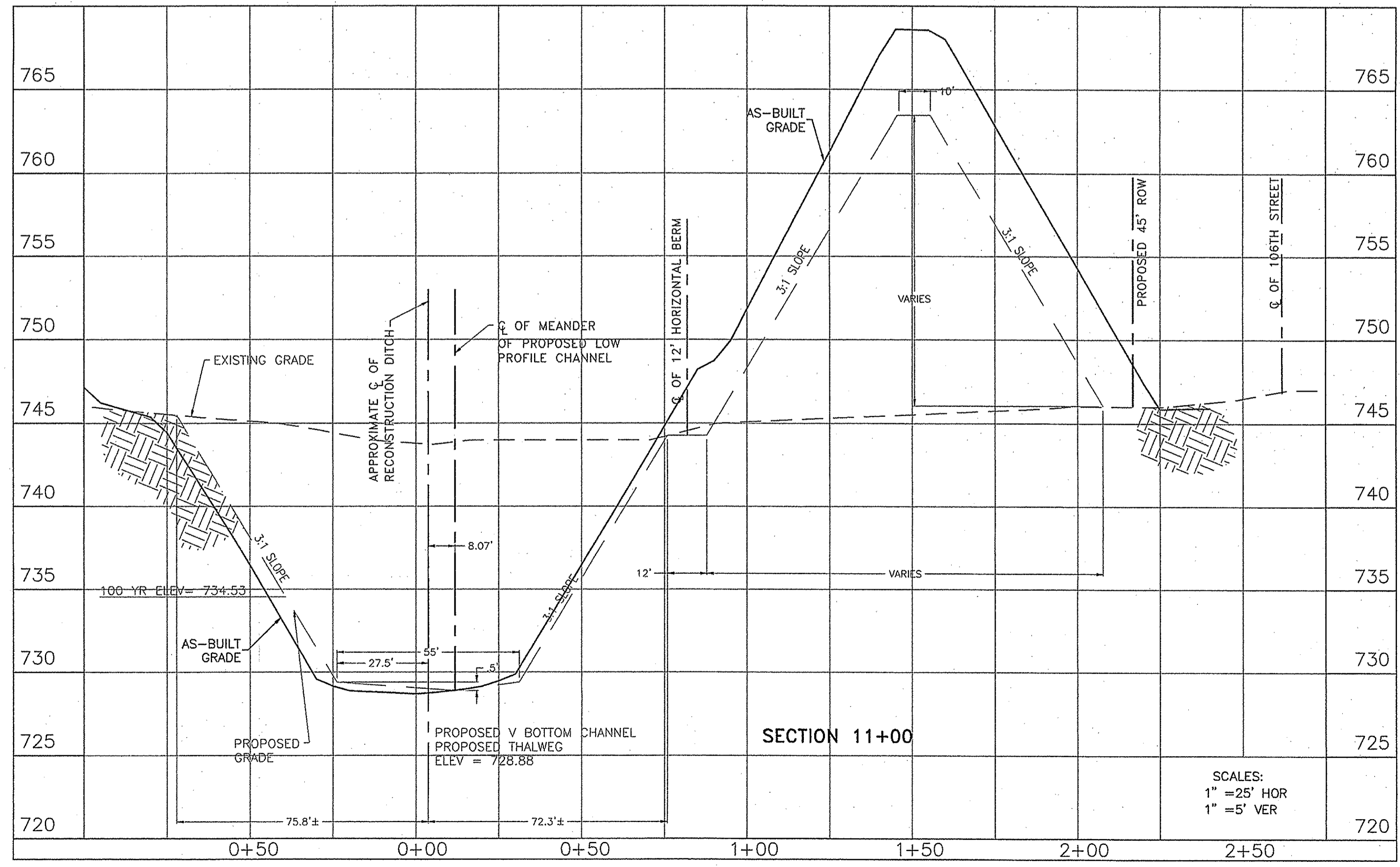
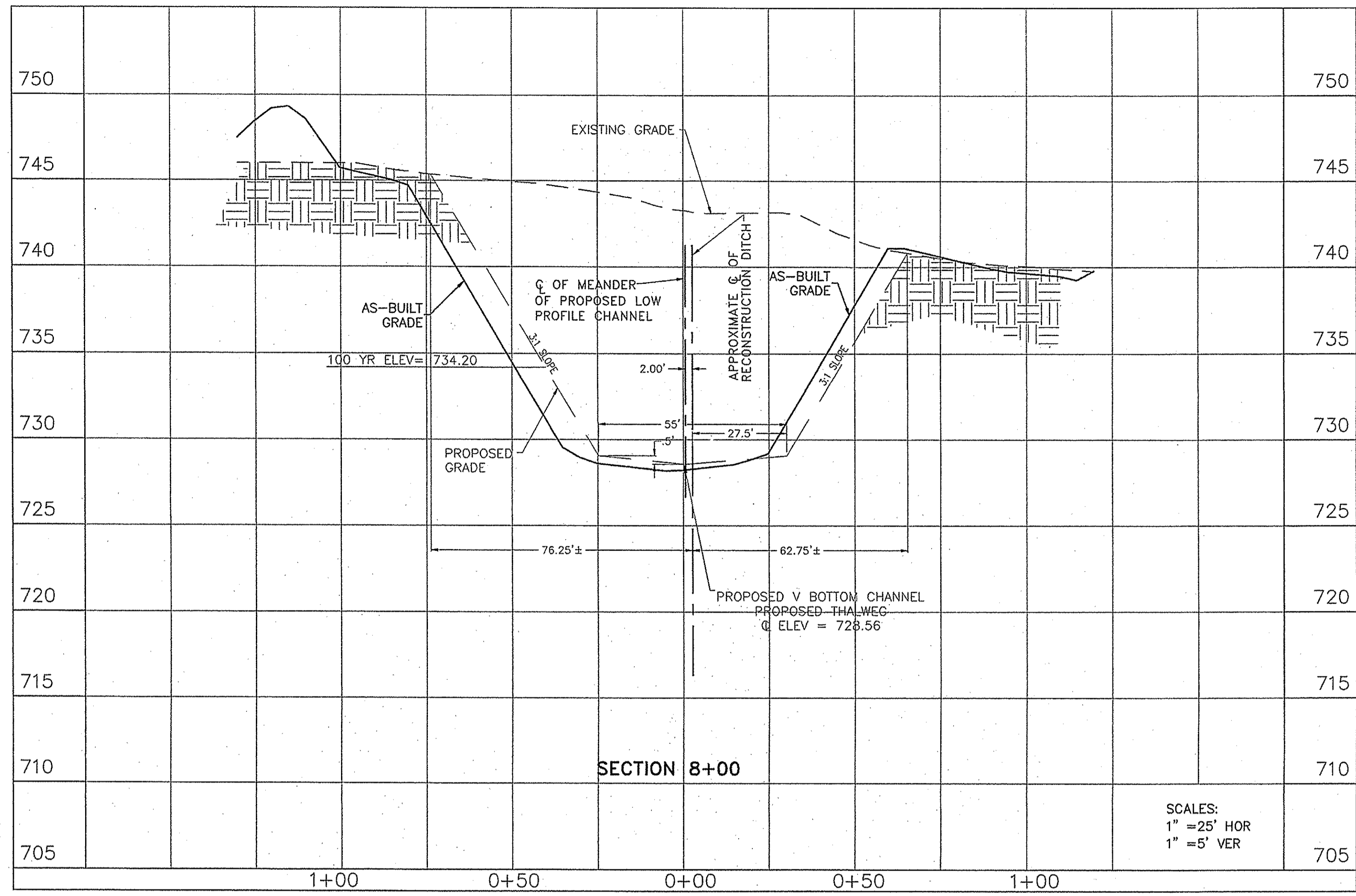
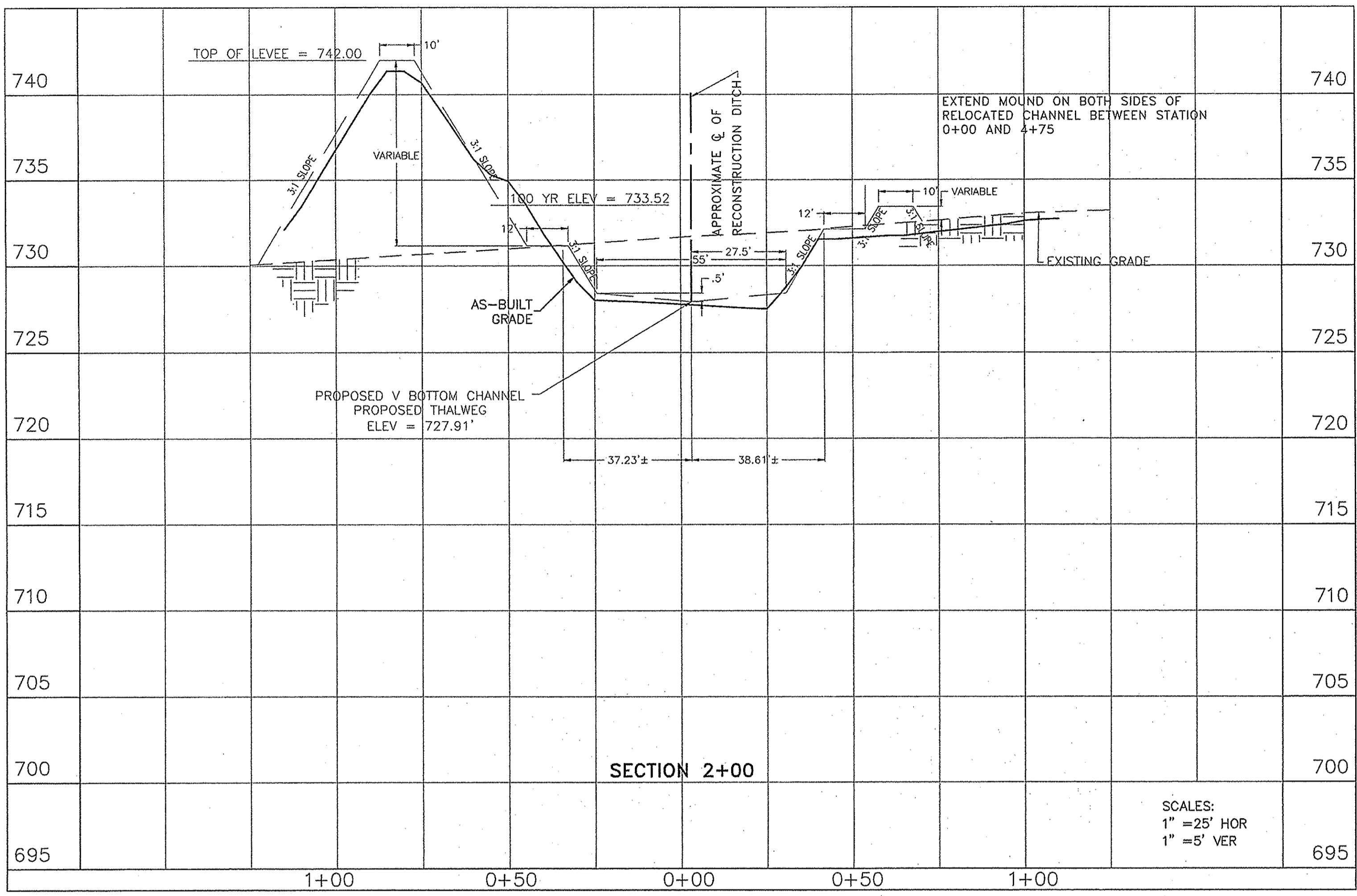

ANY EROSION THAT OCCURS THROUGH THE STRAIGHT SECTIONS OF THE RELOCATED DITCH; SHALL BE REJUVENATED AND RESTORED TO PLAN GRADE BY THE CURRENT LEASEE (MARTIN MARIETTA MATERIALS, INC.)

This information was gathered for input into the Hamilton County Geographic Information System (GIS). This document is considered an official record of the GIS.
 Entry Date: Feb 2010
 Entered By: SLM

RECORD DRAWING
 CREEK RELOCATION AS-BUILTS
 DECEMBER 7, 2009
 P. SHELL
 PATRICK C. SHEEHAN P.E. 19500338

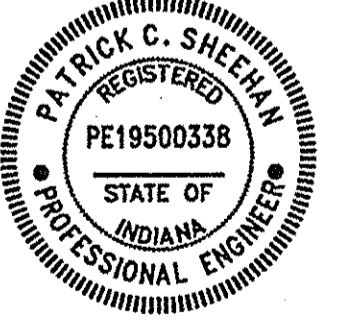

NOTE: ALL SECTIONS ARE LOOKING UPSTREAM

WEIHE ENGINEERS, INC.
 ALLAN H. WEIHE, P. E., L. S. PRESIDENT
 16005 NORTH COLLETS AVENUE
 INDIANAPOLIS, INDIANA 46224
 (317) 848-8611 FAX: (317) 843-0546
 TOLL-FREE (800) 482-6408
 CIVIL ENGINEERS • LAND SURVEYORS • LAND PLANNERS • LANDSCAPE ARCHITECTS

PROJECT NO.:	W00-0285
DATE:	11/10/09
BY:	DC
DATE:	1/23/01
BY:	DC
DATE:	3/7/01
BY:	DC
DATE:	1/8/02
BY:	DC
DATE:	6/28/02
BY:	AM
DATE:	12/7/09
BY:	AM
DATE:	
BY:	
DATE:	

REVISIONS TO ALL SHEETS
 MINOR REVISIONS TO ALL SHEETS
 CHANNEL CROSS SECTIONS MODIFIED
 GENERAL REVISIONS
 AS-BUILT SUBMITTAL

PREPARED FOR:
BLUE WOODS CREEK RELOCATION
 (MOFFIT WILLIAMSON LEGAL DRAIN)
 MARTIN MARIETTA MATERIALS, INC.

CROSS SECTION SHEET
 SHEET NO. **7**
 PROJECT NO. **W00-0285**

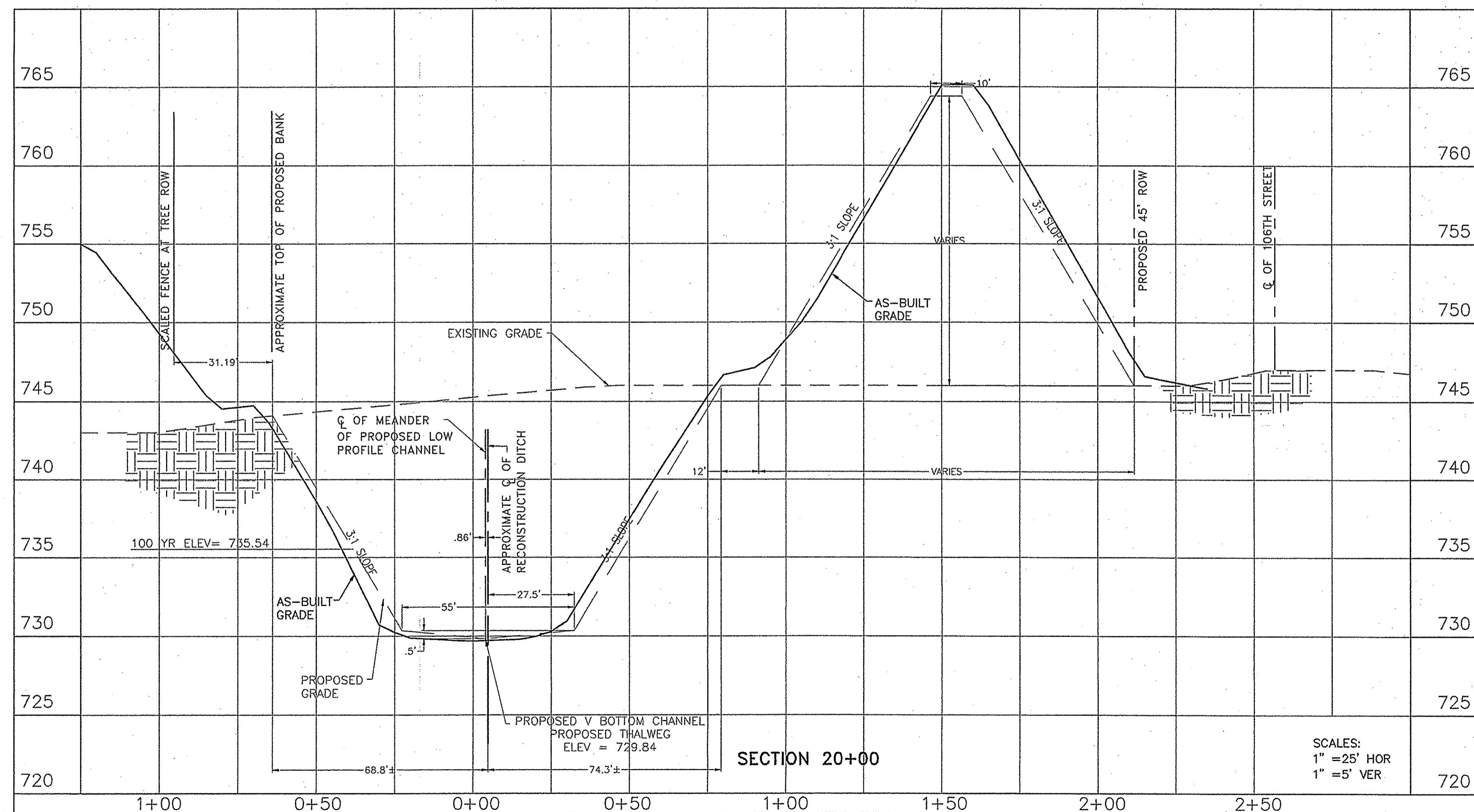
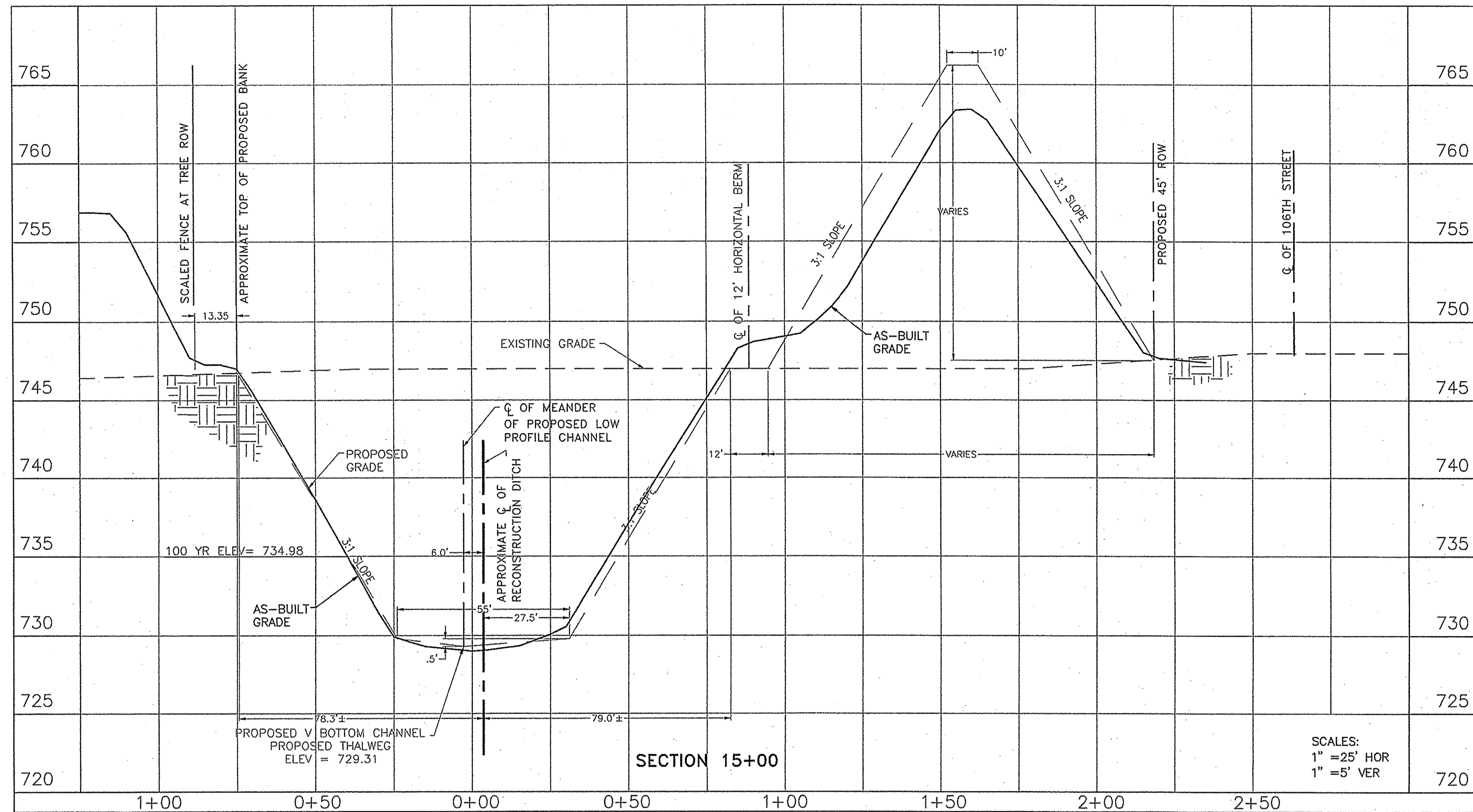

RECORD DRAWING
 CREEK RELOCATION AS-BUILTS
 DECEMBER 7, 2009

P.C.S.
 PATRICK C. SHEEHAN P.E. 19500338



ANY EROSION THAT OCCURS THROUGH THE STRAIGHT SECTIONS OF THE RELOCATED DITCH; SHALL BE REJUVENATED AND RESTORED TO PLAN GRADE BY THE CURRENT LEASEE (MARTIN MARIETTA MATERIALS, INC.)

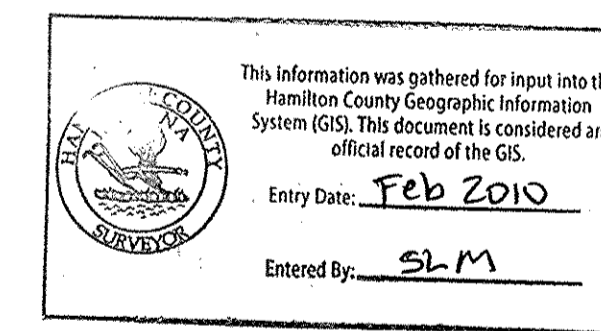

NOTE: ALL SECTIONS ARE LOOKING UPSTREAM

WEIHE ENGINEERS, INC.
 ALLAN H. WEIHE, P.E., L.S.
 PRESIDENT
 10505 NORTH COLLEGE AVENUE
 SUITE 100
 INDIANAPOLIS, IN 46240
 TEL: 317-546-1100 FAX: 317-546-0443
 TOLL-FREE: (800) 452-9408
 CIVIL ENGINEERS • LAND SURVEYORS • LAND PLANNERS • LANDSCAPE ARCHITECTS

PROJECT NO.:	W00-0285
DWG NAME:	CREEK RELOCATION AS-BUILTS
FIELD BY:	PK
DRAWN BY:	PK
CHECKED BY:	PK
DATE:	11/10/09

REVISIONS TO ALL SHEETS HAVE BEEN MADE TO ALL SHEETS CHANNEL CROSS SECTIONS MODIFIED GENERAL REVISIONS AS-BUILT SUBMITTAL

PREPARED FOR:
BLUE WOODS CREEK RELOCATION
 (MOFFIT WILLIAMSON LEGAL DRAIN)
 MARTIN MARIETTA MATERIALS, INC.
 CROSS SECTION SHEET
 Part of the 1/2 of Sec. 9-T11N-R6E & S/2 of Sec. 4-T11N-R6E, Clay Twp., Hamilton Co., Indiana

SHEET NO.
8
 PROJECT NO.
 W00-0285

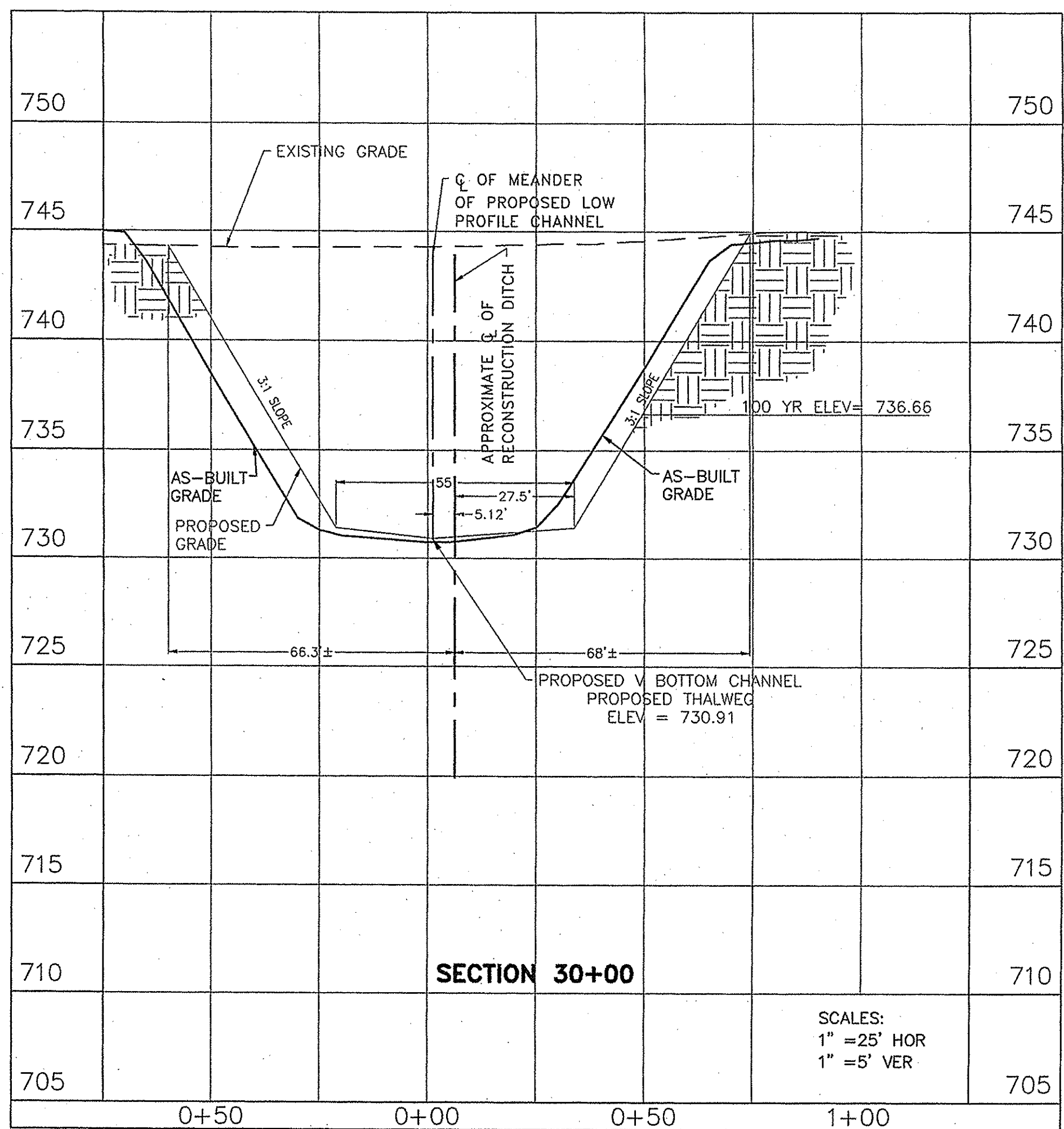
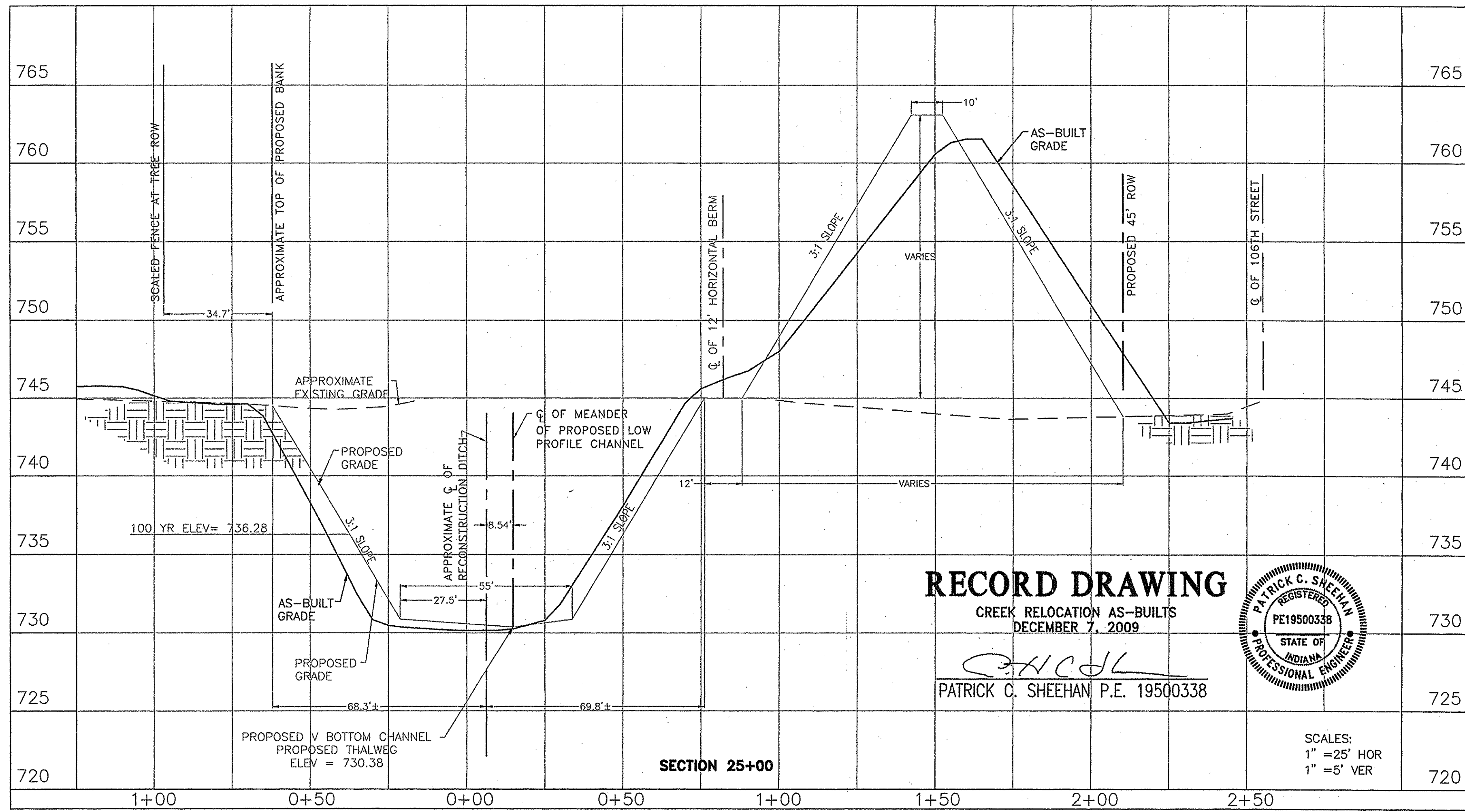

RECORD DRAWING

CREEK RELOCATION AS-BUILTS
DECEMBER 7, 2009

PATRICK C. SHEEHAN P.E. 19500338

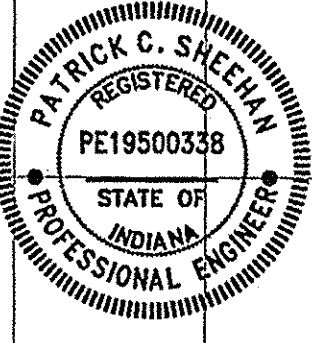

SCALES:
1" = 25' HOR
1" = 5' VER

SCALES:
1" = 25' HOR
1" = 5' VER

NOTE: ALL SECTIONS ARE LOOKING UPSTREAM

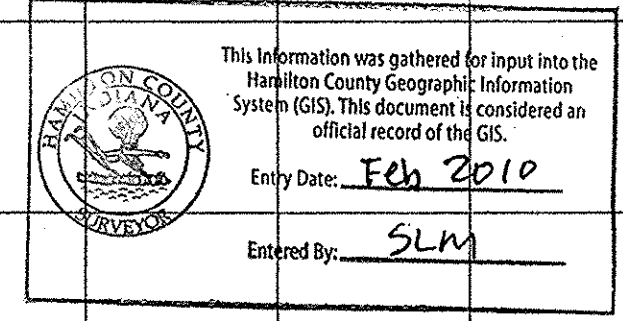
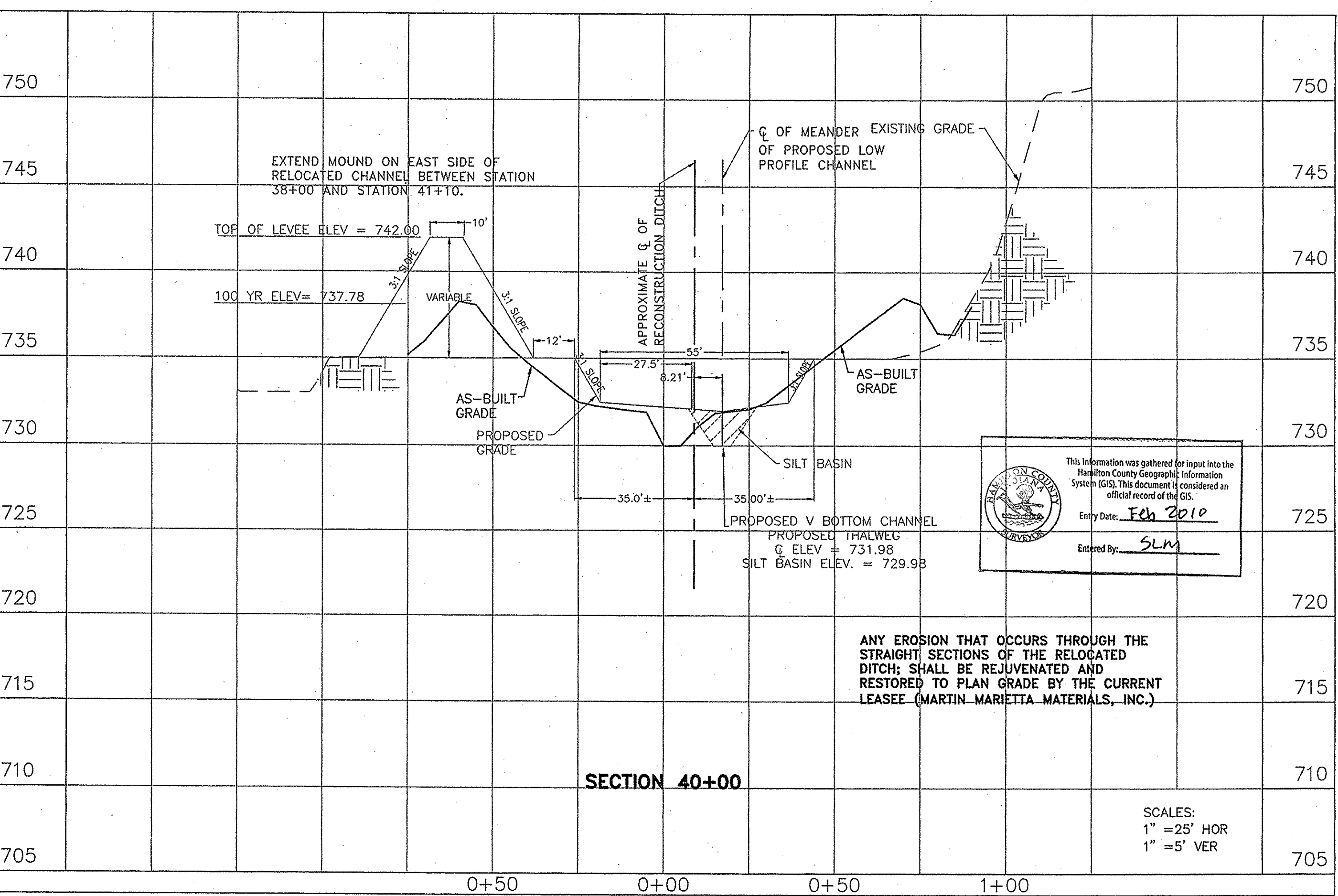
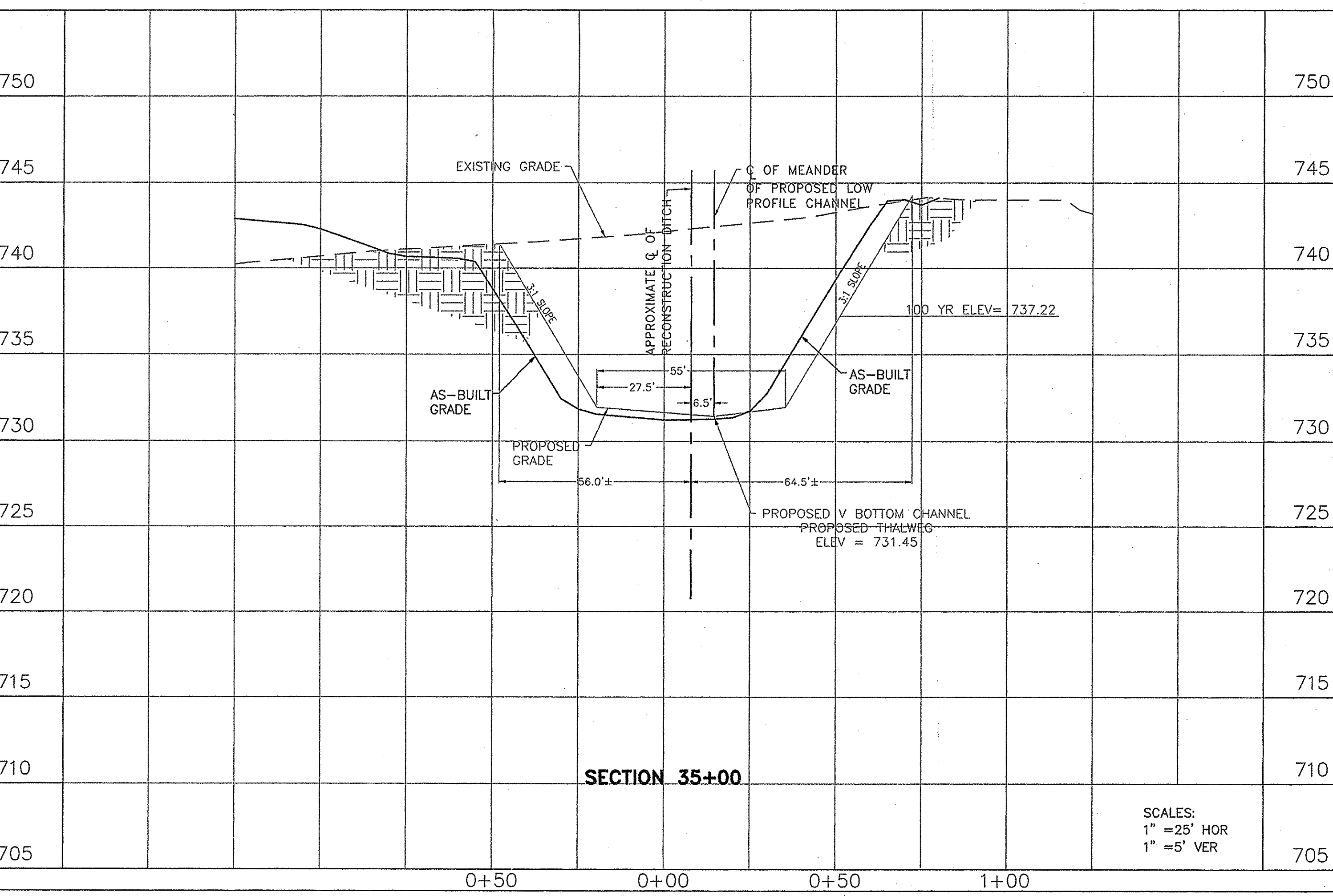

ANY EROSION THAT OCCURS THROUGH THE STRAIGHT SECTIONS OF THE RELOCATED DITCH; SHALL BE REJUVENATED AND RESTORED TO PLAN GRADE BY THE CURRENT LEASEE (MARTIN-MARIETTA MATERIALS, INC.)

SCALES:
1" = 25' HOR
1" = 5' VER

SCALES:
1" = 25' HOR
1" = 5' VER

WEIHE ENGINEERS, INC.
ALLAN H. WEIHE, P.E., I.S.
PRESIDENT
1655 INDIAN COLLEGE AVENUE
INDIANAPOLIS, INDIANA 46203
(317) 648-6811 FAX: (317) 648-0646
TOLL-FREE (800) 458-6408

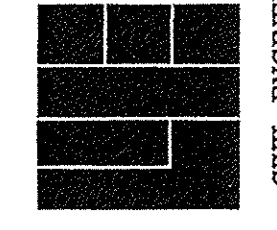

PROJECT NO.:
DWG NO.:
DATE:
BY:
DATE:
CHECKED BY:

DATE: 11/10/09

REVISIONS:
REVISIONS TO ALL SHEETS
MINOR REVISIONS TO ALL SHEETS
CHANNEL CROSS SECTIONS MODIFIED
GENERAL REVISIONS
AS-BUILT SUBMITTAL

BLUE WOODS CREEK RELOCATION
(MOFFIT WILLIAMSON LEGAL DRAIN)
MARTIN MARIETTA MATERIALS, INC.
CROSS SECTION SHEET
Prep. by: SLM
Date: 2/10/10

PROJECT NO.
9
W00-0285